

CONCEPTUAL MASTER PLANNING

FIRST STEP IN PLANNING MODERNIZED HIGH SCHOOLS

Determine each school's overall program needs, site layout, and estimated costs for modernization and new construction options

This information will help PPS in the planning of future capital improvement bonds

PPS Board currently in the process of planning for the next bond

Once a school is part of a bond, PPS will move forward with comprehensive master planning process to provide timely and relevant guidance for the design

CONCEPTUAL MASTER PLANNING COMMITTEE (CMPC)

The CMPC consists of parents, teachers, students, and community stakeholders who work together to help provide feedback for the development of conceptual master plans

CMPC members synthesize community-wide input and share the evolving details of the project to others in the community

Their input is critical in creating a design that the entire community can be proud of

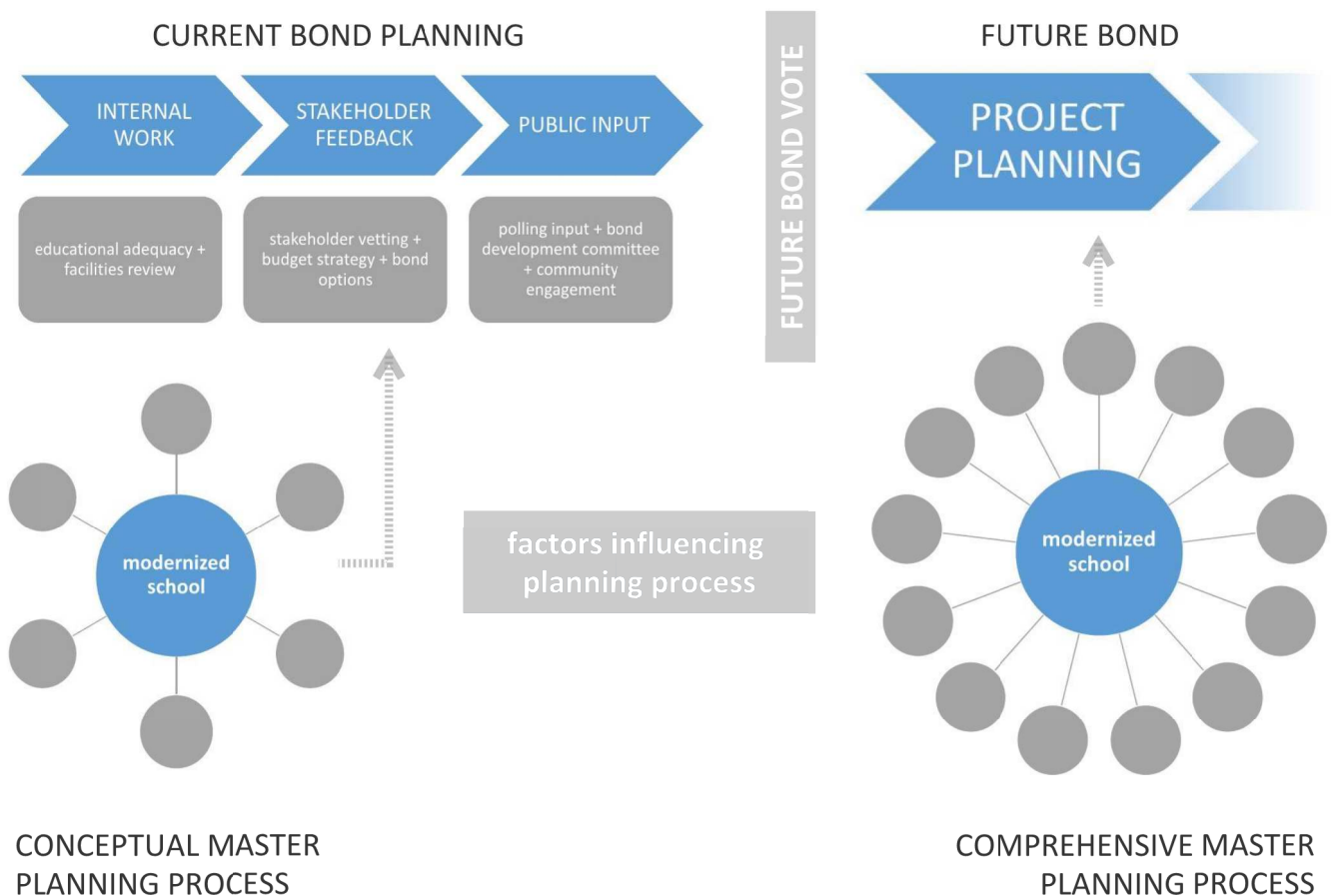

CMPC 1 - VISION & GOALS

PPS VISION & GOALS

LESSONS LEARNED FROM 2012 & 2017

DISTRICT VISION / CORE VALUES

EDUCATION SPECIFICATIONS

DISTRICT FACILITY GOALS

- Equity
- Universal Access
- Safety
- Resilience
- Sustainability
- Energy Efficiency

DISTRICT VISION

A graduate of Portland Public Schools will be a compassionate critical thinker, able to collaborate and solve problems, and be prepared to lead a more socially just world.

DISTRICT CORE VALUES

- Students at the Center
- Racial Equity and Social Justice
- Honesty and Integrity
- Excellence
- Respect
- Relationships
- Creativity and Innovation
- Partnerships and Collaboration
- Grounded in the Spirit of Portland
- Joyful Learning and Leadership

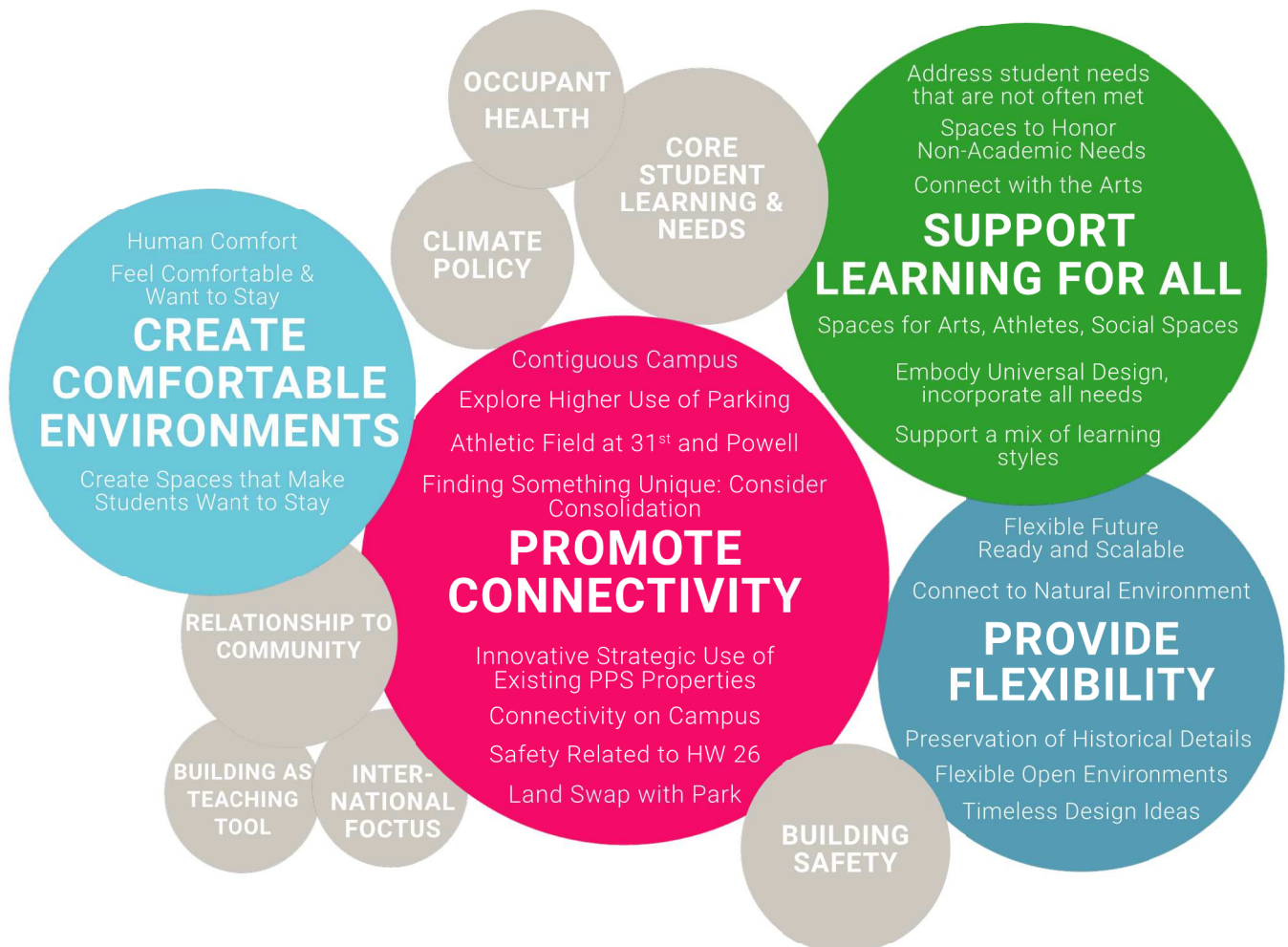

CMPC 2 - PROGRAM & ANALYSIS

	TEACHING STATIONS			SQUARE FOOTAGE		
	ED SPEC	CHS	CHS CMP	ED SPEC	CHS CURRENT	CHS CMP
General Education Classrooms	41	47	41-47	53,180	39,394	53,180*
Science Labs	11	10	11	17,480	15,607	17,480
Career Preparation/CTE	3	5	5	6,000	8,722	8,720
Fine & Performing Arts (Drama, Theater)	4	6	6	21,150	24,232	27,500
Athletics (includes area for PE instruction)	3	3	3	35,580	31,483	35,580
Education Support	2	1	2	67,400	50,232	67,400
Community Partners				1,200	289	1,200
Wrap-Around Service Providers				4,700	1,025	4,700
SUB-TOTAL	64	72	68-74	206,690	170,984	214,260
Net to Gross Ratio of 36% (49%) (36%)				74,408	83,271	77,134
TOTAL COMPREHENSIVE HIGH SCHOOL REQUIRED AREA				281,098	254,255	293,434

* ASSUMES TEACHING STATIONS COUNT ALIGNED WITH ED SPEC
DENOTES DEVIATION FROM ED SPEC

KEY PROGRAM OBSERVATIONS

(What makes Cleveland unique?)

- :: More teaching stations vs. Ed Spec (IB); **Smaller** average classroom areas
- :: **Lacking smaller instruction** and flexible learning spaces
- :: **Auditorium** exceeds EdSpec size for Theater, but lacks key support spaces
- :: Higher number of **Arts** classrooms, including Optional Choir Room
- :: Undersized **Main Gymnasium**
- :: Lack of **Auxiliary Gymnasium**
- :: Lack of **Teacher's offices** & undersized **Administrative** spaces
- :: Undersized **Career Center, Library & Commons**
- :: Lack of **Teen Parent** space

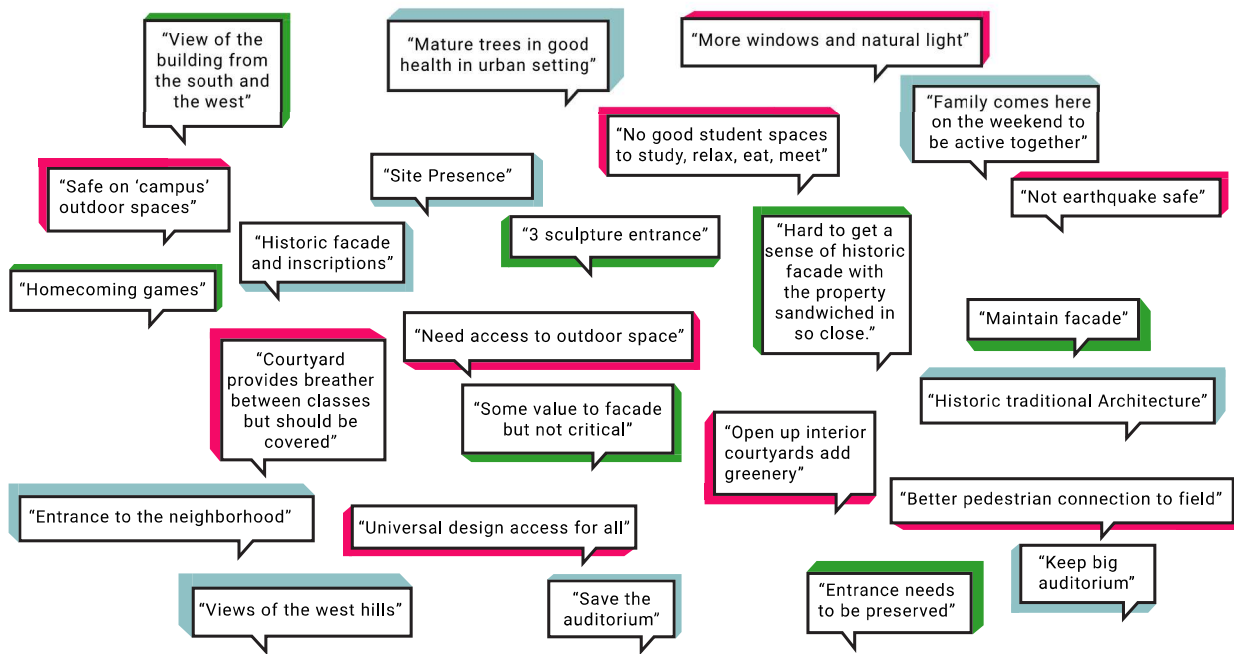

- Facades & Inscriptions (1)
- Theater / Auditorium (1)
- Gymnasium (4)
- Site Presence (3)
- Urban tree canopy (3)
- Library (2)
- Track and Field (1)
- Powell Park (2)



- Facades & Inscriptions (13)
- Theater / Auditorium (5)
- Presence on Powell Blvd (7)
- Urban tree canopy (2)
- Historic Entrance (2)



- Safety & Security (2)
- More natural light (1)
- More space (1)
- Outdoor open space (1)
- More welcoming (4)
- More flexible student space (7)
- Lacks universal access (4)
- Old HVAC (5)
- Incorporate renewable energy (5)
- Outdated technology (2)



CMPC 3 - CONCEPT DEVELOPMENT

MASSING CONCEPT

HISTORIC :: CONSOLIDATED

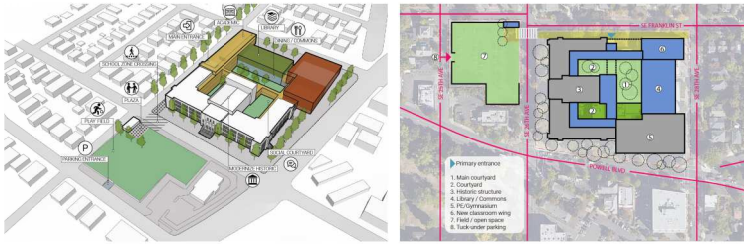

MASSING CONCEPT

HISTORIC :: DISTRIBUTED

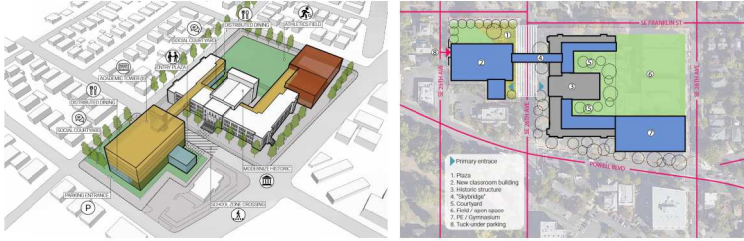

MASSING CONCEPT

PARTIAL HISTORIC :: DISTRIBUTED

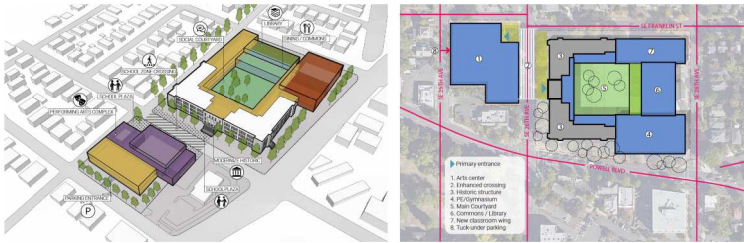

MASSING CONCEPT

NEW :: CONSOLIDATED



MASSING CONCEPT

NEW :: DISTRIBUTED



How should the following spaces be organized in order to foster a strong sense of community?

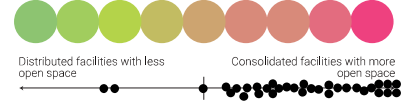
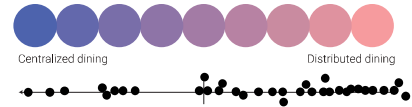
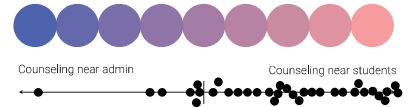
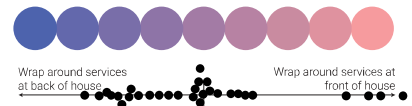

How should the site massing and open space be arranged to encourage site continuity and safety?



How can the building design provide for future needs and flexibility while maintaining the values of Cleveland High School?

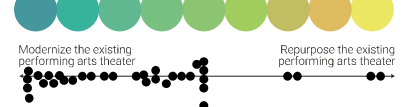
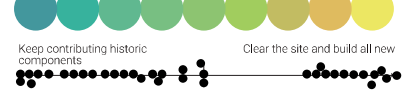

How should the following spaces be organized in order to address student needs and comfort?

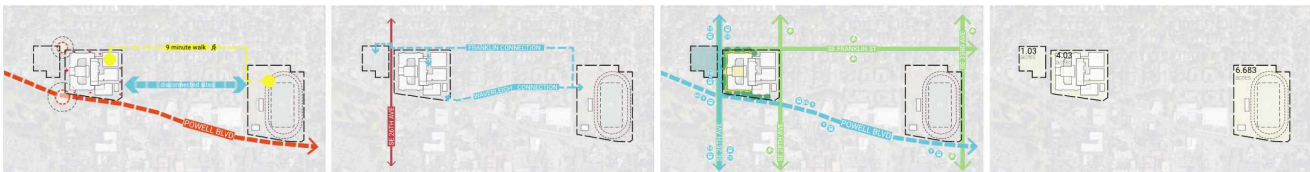
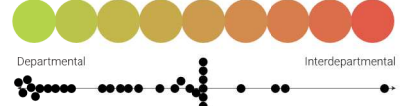
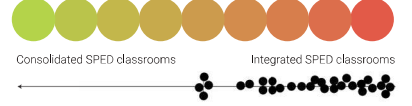
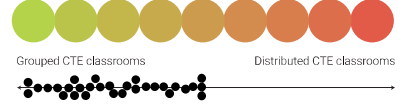

CMPC 4 - CONCEPT REFINEMENT

HISTORIC :: DISTRIBUTED

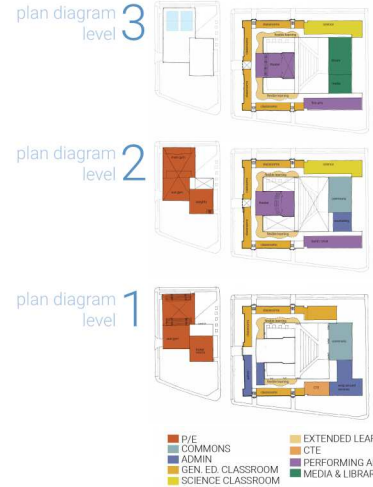
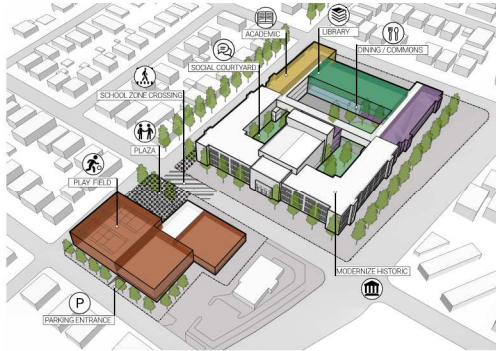
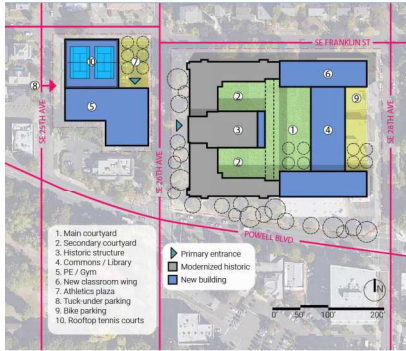

OPPORTUNITIES

- Preserve cultural history
- Utilize existing historic building
- Internal, safe open space
- Smaller pockets of open space

CHALLENGES

- Crossing 26th ave
- Underutilized parking lot
- Small interior courtyards

Utilizing both sites for building program provides more opportunity for larger open space.

ADDITIONAL CONSIDERATIONS

- Brochings athletic courts over gym
- Skybridge across SE 26th Ave
- Enhanced connection to Stadium via Franklin Avenue

PARTIAL HISTORIC :: DISTRIBUTED

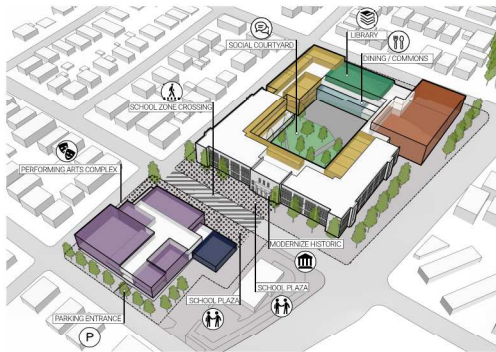
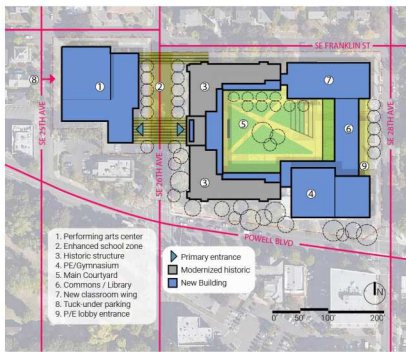

OPPORTUNITIES

- Large protected courtyard
- Performing arts complex

CHALLENGES

- Crossing 26th ave
- Minimize crossings - place more free arts classrooms in main building
- Maintenance of large open space

Provide service access to courtyard

ADDITIONAL CONSIDERATIONS

- Explore potential for temporary street closures during school hours
- Programming interior courtyard to include handicapped and smaller social gathering spaces
- Enhanced connection to Stadium via Waverleigh

NEW :: CONSOLIDATED

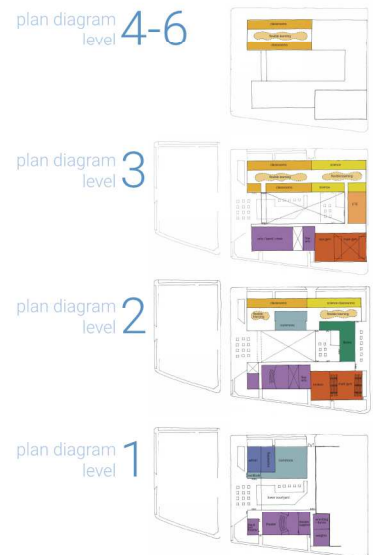
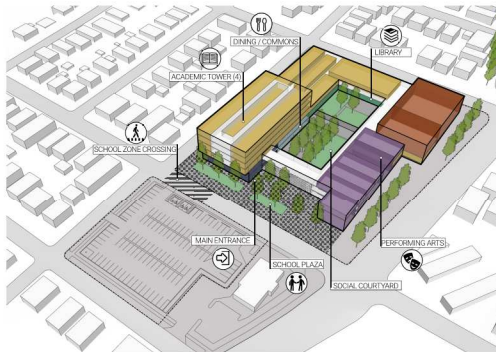

OPPORTUNITIES

- Entry plaza away from 26th and Powell
- Future opportunity for parking lot site
- Artistic, future expansion, swimming

CHALLENGES

- Powell is noisy
- Questionable demand for athletic outdoor space on main site

Site plan program to create enclosed / secure open social space

ADDITIONAL CONSIDERATIONS

- Potential to reduce to 5 floors by spreading classrooms
- Multi-level outdoor space for programming