



Grant Modernization

A \$158 million investment in Northeast Portland



Center hall - new three story stair

Construction work enters the home stretch

Inside the modernized Grant High School the science wing, at the north end of campus, is largely finished with just a few details to add. In the new library, all of the shelving has been installed and in the student commons/cafeteria, crews are installing the kitchen and serving equipment.

The auditorium ceiling has been entirely refurbished with new acoustic panels and upgraded plaster work and rigging is being installed in the stage area. In the new athletics building scoreboards, lighting, fans, AV systems are in place and new wood floors are being installed.

On the exterior, landscaping is underway and construction of the artificial turf baseball and multi-use fields is in full swing. Final touches, painting, cabinetry, and flooring are happening everywhere in the building.

Modernized Grant to open August 2019

Grant will reopen for students for the first day of school on August 28th. The Grand Opening is planned for Saturday, September 7, 2019.

Some sports to remain at Marshall through summer

The Grant campus will remain an active construction site through most of the summer. This means that many summer sport activities will remain at Marshall or take place at other sites. Please consult with your coaches to determine where you will practice this summer.



Student tour group



West side addition

Project Timeline

SPRING 2015 – SPRING 2017

Planning & Design

Master Planning / Schematic Design /
Design Development /
Construction Documents

SUMMER 2017 – SUMMER 2019

Construction

The Grant Community will relocate to the Marshall Campus for the 2017-18 and 2018-19 school years.

FALL 2019

Fully modernized Grant opens

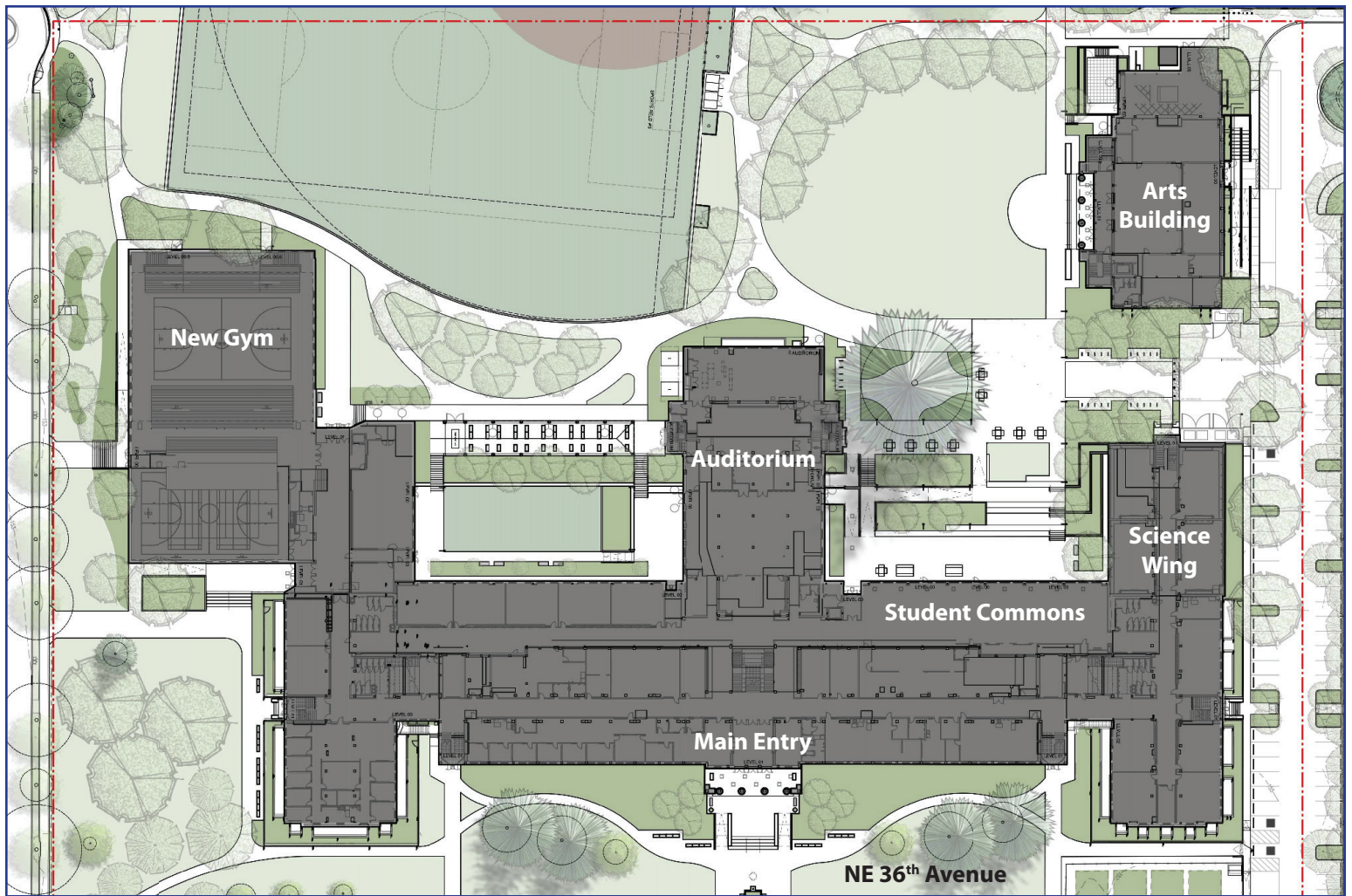

New School Layout

When people enter the newly modernized Grant they will be greeted by a new, three story staircase that is a central hub of the school connecting the entryway to the auditorium, student commons and the new maker space.

Behind the stairs is the fully renovated historic auditorium and nearby is a new 165 seat Blackbox Theater, an ideal location for one-act plays. Adjacent to the Blackbox is a new dance studio and a flex space for gathering, and practicing.

Grant's new library spans the southwest addition. The student commons/cafeteria is located on both the lower and main levels of the school. The lower level commons connects directly to the north courtyard, with places to eat outside.

The science wing, located in the northwest corner of the main building, is comprised of 12 science classrooms. Visual Arts is now located in the original 1923 Gym building housing seven classrooms for 2D art, 3D/Ceramics, Digital Photography, Printmaking, Graphic Design and Digital Media.

The campus also includes a new athletic facility located in the SW corner of campus with a main gym with seating for 1700, an auxiliary gym, wrestling room, and weight room with access to an artificial turf courtyard for use by the athletes and PE classes.

Grant Modernization Highlights

- A welcoming three-story common area providing a community gathering space
- A visual arts complex in the 1923 gym housing studio classrooms, digital media labs and an art gallery
- A new athletic building featuring a gym that accommodates up to 1700 students for assemblies, an auxiliary gym and weight room
- Restored historic auditorium outfitted with all new lights, rigging, and drapes. A black box theater will be located on the ground level.
- Student-based health center and teen parent clinic

BUILDING OUR FUTURE TOGETHER.

<http://GrantBond.pps.net> • GHsmod@pps.net • Phone: 503-916-2222

f www.facebook.com/PPSGrantHighSchool @ccampbellIGHS

Portland Public Schools
School Building Improvement Bond



Portland Public Schools is an affirmative action and equal opportunity employer.