



Engineering +
Environmental

November 29, 2016

Courtney Wilton
Portland Public Schools
501 North Dixon
Portland, OR 97227

Via email: cwilton@pps.net

Regarding: Lead Paint Condition Assessment
Beach Elementary School
1710 N Humboldt Street
Portland, OR 97217
PBS Project: 6500.721 Phase 0007

Dear Mr. Wilton:

On November 9 and 14, 2016, PBS Engineering and Environmental Inc. conducted a visual assessment of painted and varnished surfaces on the interior and exterior of Beach Elementary School located at 1710 N Humboldt Street in Portland, Oregon.

For the sake of this investigation, it is assumed that all paint and varnish at the school contain some concentration of lead. The purpose of this investigation is to identify finishes that are in poor (deteriorated) condition.

PBS visually inspected interior and exterior hard surfaces and soil adjacent to painted surfaces. The locations of concrete, garden spaces, compost piles, playground equipment, and windowsills in close proximity to deteriorated paint were also noted.

FINDINGS

Paint and varnish conditions were assessed using US Department of Housing and Urban Development (HUD) guidelines for the Evaluation and Control of Lead Based Paint Hazards in Housing (2012 Addition) Chapter 5: Risk Assessment and Reevaluation.

Overall, the building's painted and varnished surfaces were found to be in fair to intact condition with areas of deteriorated conditions. A table showing the location and quantity of surfaces in deteriorated condition is attached to this report.

Paint chips were observed on concrete and soil on the east and north sides of the "P" portable.

PBS did not observe any paint chips in the garden, which is located approximately 10 feet from the west side of the "P" portable. The condition of the paint on the west side of "P" portable was intact. No paint chips were observed on the compost pile, which is located in the garden area on the west side of "P" portable.

Windows throughout the campus are metal (non-painted) framed. No evidence of paint chips were observed in representative window toughs inspected.

An area of high concern noted during PBS' visit was the P1 preschool classroom where peeling paint was observed above the P3 door. This area was subsequently addressed on November 15, 2016, by a remediation contractor who stabilized the paint

4412 SW Corbett Avenue, Portland, OR 97239
503.248.1939 Main
866.727.0140 Fax
888.248.1939 Toll-Free
www.pbsenv.com

Painted playground and parking lot striping and curbing often contain lead and are generally in deteriorated condition due to weatherization and traffic. PBS did not assess this paint, but recommends restriping, as needed, to maintain in good condition.

RECOMMENDATIONS

PBS recommends that all painted or varnished surfaces in deteriorated condition be stabilized. Paint chips on concrete and soil on the east and north sides of the "P" portable should be removed.

Please feel free to contact me at 503.417.7576 or steved@pbsenv.com with any questions or comments.

Sincerely,
PBS Engineering and Environmental Inc.



Steve Dilling
Project Manager

Attachments: Condition Assessment of Deteriorated Paint/Varnish Table
Field Drawing of Deteriorated Paint and Varnish Locations
Lead-based Paint Risk Assessor Certification (Steve Dilling)
Lead-based Paint Activities Firm Certification (PBS Engineering and Environmental)

Beach Elementary School
Assessment of Paint/Varnish in Deteriorated (Poor) Condition

ID	Interior / Exterior	Location	Room Name/ #	Structure	Above / Below five feet	K-2nd Grade	Substrate	Quantity
A	Interior / Exterior	Main office hallway entrance door	N/A	Varnished and painted door	Below	Yes	Wood	2 EA
B	Exterior	Parking lot; hand rail	N/A	Painted hand rail	Below	Yes	Metal	10 SF
C	Exterior	Main entrance hand rail	N/A	Painted hand rail	Below	Yes	Metal	5 SF
D	Exterior	Flag pole	N/A	Painted flag pole	Above/Below	Yes	Metal	20 SF
E	Exterior	Northeast entrance hand rail	N/A	Painted hand rail	Below	Yes	Metal	5 SF
F	Exterior	Southwest cafeteria entrance	N/A	Painted hand rail and posts	Below	Yes	Metal	5 SF
G	Exterior	Southwest lower hallway entrance	N/A	Painted hand rail and posts	Below	Yes	Metal	10 SF
H	Exterior	Playground walkway posts	N/A	Painted posts	Below	Yes	Metal	25 SF
I	Exterior	Playground	N/A	Painted playground surfaces	Below	Yes	Pavement	500 SF
J	Exterior	Northwest corner of playground	N/A	Painted transformer and associated posts	Below	Yes	Metal	20 SF
K	Exterior	Northwest playground stairwell	N/A	Painted concrete wall	Below	Yes	Concrete	20 SF
L	Exterior	Southwest "P" portables northwest entrances	N/A	Painted hand rails	Below	Yes	Metal	20 SF
M	Exterior	Southwest "P" portables northwest main entrance	N/A	Painted support beams	Below	Yes	Wood	10 SF
N	Exterior	Southwest "P" portables downspout guard	N/A	Metal downspout guard	Below	Yes	Metal	5 SF
O	Exterior	Southwest "P" portables north storage shed wall	N/A	Painted wall	Above/Below	Yes	Wood	150 SF
P	Exterior	Southwest "P" portables east roof overhang	N/A	Roof overhang	Above	Yes	Wood	60 SF
Q	N/A	N/A	N/A	N/A	N/A	Yes	N/A	N/A
R	Exterior	Southwest "P" portables southeast staircase	N/A	Staircase and hand rail	Below	Yes	Metal	40 SF
S	Exterior	South "P" portable side	P3	Roof overhang	Above	Yes	Metal	60 SF
T	Exterior	South "P" portable side	P4	Rain drain downspout	Above/Below	Yes	Metal	20 SF
U	Exterior	South "P" portable side	P2	Siding	Above/Below	Yes	Wood	250 SF
V	Exterior	East side "P" portable	P2	Paint chips	Below	Yes	Soil	40 SF
W	Exterior	East side "P" portable	P1	Paint chips	Below	Yes	Asphalt	50 SF

ID	Interior / Exterior	Location	Room Name/ #	Structure	Above / Below five feet	K-2nd Grade	Substrate	Quantity
X	Exterior	North side "P" portable	P1	Paint chips	Below	Yes	Asphalt	40 SF
Y	Exterior	South side of main building	N/A	Basketball and teatherabl poles	Below	Yes	Metal	32 SF
Z	Exterior	West of A wing portable to street	N/A	Hand and guard rails	Below	Yes	Metal	40 SF
AA	Interior	Main office entry and stairwell	104	Cementitious covebase and skirt	Below	Yes	Magnasite	100 SF
AB	Interior	Library	102	Varnish door and frame	Below	Yes	Wood	1 door and 15 SF
AC	Interior	Library sink area	102	Varnish lower door faces	Below	Yes	Wood	25 SF
AD	Interior	Classroom storage	100	Varnish door and frame	Below	No	Wood	1 door and 15 SF
AE	Interior	Classroom storage north and west wall	100	Baseboard	Below	No	Wood	50 SF
AF	Interior	Corridor near room 100	N/A	Lockers	Below	No	Metal	31 Assemblies
AG	Interior	Girls restroom near room 100 storage	N/A	Varnished door frame	Below	No	Wood	30 SF
AH	Interior	Custodial room	1C	Varnished door, frame and shelves	Above	No	Wood	1 door and 100 SF
AI	Interior	Custodial room	1C	Walls	Above/Below	No	Plaster	25 SF
AJ	Interior	Main corridor near office	N/A	Fix cabinet	Below	Yes	Metal	5 SF
AK	Interior	Boys restroom	103	Varnished door	Below	Yes	Wood	1 door
AL	Interior	Nurse	105	Varnished interior door to Boys restroom	Below	Yes	Wood	1 door
AM	Interior	Gym door to corridor	107	Varnished doors	Below	Yes	Wood	4 doors
AN	Interior	Gym	107	Walls below 6 feet	Below	Yes	Plaster and concrete	1050 SF
AO	Interior	Gym office and storage	107C/B	Window sills	Below	Yes	Wood	6 SF
AP	Interior	Main corridor	N/A	Lockers	Below	Yes	Metal	78 EA
AQ	Interior	Girls restroom	111	Varnished door	Below	Yes	Wood	2 doors
AR	Interior	Custodial room	1C2	Varnished door, frame and shelves	Above/Below	No	Wood	1 door and 75 SF
AS	Interior	Corridor near room 116	N/A	Lockers	Below	Yes	Metal	36 EA
AT	Interior	Boys restroom	115	Partitions	Below	Yes	Metal	100 SF
AU	Interior	Boys restroom west wall	115	Walls	Below	Yes	Plaster	100 SF

ID	Interior / Exterior	Location	Room Name/ #	Structure	Above / Below five feet	K-2nd Grade	Substrate	Quantity
AV	Interior	Boys restroom	115	Varnished doors and frame	Below	Yes	Wood	2 doors and 30 SF
AW	Interior	Southeast stairwell to basement	N/A	Varnished door frame	Below	Yes	Wood	30 SF
AX	Interior	Southeast stairwell to basement	N/A	Cementitious covebase	Below	Yes	Magnasite	65 SF
AY	Interior	Teacher work room	120	Wall and ceiling soffet	Above/Below	No	Plaster	75 SF
AZ	Interior	Computer classroom	118	Radiator cover	Below	No	Metal	15 SF
BA	Interior	Classroom	116	Radiator cover	Below	No	Metal	15 SF
BB	Interior	Classroom	116	Built-in cabinet faces and chalkbaord frames	Below	No	Wood	75 SF
BC	Interior	Classroom	116	Baseboard	Below	No	Wood	50 SF
BD	Interior	East Corridor	N/A	Doors and frame	Below	Yes	Wood /Metal	2 doors and 20 SF
BE	Interior	Classroom	114	Varnish door and frame	Below	No	Wood	1 door and 15 SF
BF	Interior	Classroom	114	Baseboard	Below	No	Wood	20 SF
BG	Interior	Northeast entry and stairwell	N/A	Cementitious covebase	Below	Yes	Magnasite	100 SF
BH	Interior	Northeast entry	N/A	Varnish door	Below	Yes	Wood	2 doors
BI	Interior	Counciling room	112	Varnish door	Below	Yes	Wood	1 door
BJ	Interior	Auditorium doors	108/108 A	Varnish doors	Below	Yes	Wood	6 doors
BK	Interior	Auditorium	108	Baseboard throughout the stage trim	Above/Below	Yes	Wood	225 SF
BL	Interior	Auditorium	108	Walls	Above/Below	Yes	Plaster	150 SF
BM	Interior	Auditorium stage 3	108	Stairs	Below	Yes	Concrete	55 SF
BN	Interior	Auditorium stage	108	Varnish stage door	Below	Yes	Wood	500 SF
BO	Interior	Office break room sink area	106	Varnish cabinet faces	Below	No	Wood	15 SF
BP	Interior	Office break room	106	Door frame	Below	No	Wood	15 SF
BQ	Interior	Classroom / music room	B22	Walls	Below	Yes	Plaster	75 SF
BR	Interior	Classroom / music room	B22	Baseboard	Below	Yes	Wood	40 SF
BS	Interior	Classroom / music room	B22	Varnish door	Below	Yes	Wood	1 door

ID	Interior / Exterior	Location	Room Name/ #	Structure	Above / Below five feet	K-2nd Grade	Substrate	Quantity
BT	Interior	Classroom storage	B21	Window sills and trim	Below	No	Wood	25 SF
BU	Interior	Classroom storage	B21	Sink and lower door faces	Below	No	Wood	30 SF
BV	Interior	Classroom storage	B21	Varnish door	Below	No	Wood	1 door
BW	Interior	Basement, southwest restroom across from room #B21	N/A	Door frame	Below	Yes	Wood	15 SF
BX	Interior	Custodial closet #BC-1	BC-1	East wall	Below	No	Gypsum	50 SF
BY	Interior	Kitchen; doors to corridor	N/A	Varnished doors and frame	Below	No	Wood	2 doors and 25 SF
BZ	Interior	Kitchen storage area	N/A	Walls	Above/Below	No	Wood and plaster	150 SF
CA	Interior	Cafeteria south wall	N/A	Wall	Below	Yes	Plaster	150 SF
CB	Interior	Boiler room / fan room	N/A	Walls, ceilings and floors	Above/Below	No	Concrete	10,000 SF
CC	Interior	Basement staff lounge	B18	Varnished cabined faces	Below	No	Wood	25 SF
CD	Interior	Basement corridor doors	B19/B19 A	Varnish doors	Below	No	Wood	4 doors
CE	Interior	Workroom	B14	Window sills	Below	No	Wood	20 SF
CF	Interior	Activity room	B17	Varnish door and frame	Below	Yes	Wood	1 door and 10 SF
CG	Interior	Activity room	B17	Varnish cabinet faces	Below	Yes	Wood	35 SF
CH	Interior	Southwest second floor stairwell	N/A	Varnished wall cap	Below	Yes	Wood	20 SF
CI	Interior	Classroom	200	Varnished cabinet doors	Below	No	Wood	3 EA
CJ	Interior	Second floor southwest hallway	N/A	Lockers	Below	Yes	Metal	22 EA
CK	Interior	Classroom	202	Varnish door fame	Below	No	Wood	15 SF
CL	Interior	Classroom	204	Varnished door and frame	Below	No	Wood	1 door and 15 SF
CM	Interior	Storage room	N/A	Varnish door	Below	No	Wood	1 door
CN	Interior	Storage room	N/A	Painted ladder	Above/Below	No	Metal	10 SF
CO	Interior	Storage room	N/A	Painted roof access hatch	Above	No	Wood	5 SF
CP	Interior	North hallway second floor	N/A	Lockers	Below	No	Metal	93 EA
CQ	Interior	Classroom	204	Painted radiator cover	Below	No	Metal	10 SF

ID	Interior / Exterior	Location	Room Name/ #	Structure	Above / Below five feet	K-2nd Grade	Substrate	Quantity
CR	Interior	Classroom	204	Painted cabinets	Below	No	Wood	10 SF
CS	Interior	Classroom	206	Painted door frame and varnished door	Below	No	Wood	1 door and 15 SF
CT	Interior	Classroom north and east walls	206	Baseboard	Below	No	Wood	20 SF
CU	Interior	Classroom	206	Cabinets	Below	No	Wood	20 SF
CV	Interior	Classroom	208	Varnished door and frame	Below	No	Wood	1 door and 15 SF
CW	Interior	Classroom	208	Baseboard	Below	No	Wood	50 SF
CX	Interior	Classroom	208	Cabinets	Below	No	Wood	20 SF
CY	Interior	Classroom	214	Radiator cover	Below	No	Metal	10 SF
CZ	Interior	Classroom south and west walls	214	Baseboard	Below	No	Wood	25 SF
DA	Interior	Classroom	212	Varnished cabinet faces	Below	No	Wood	3 EA
DB	Interior	Classroom	212	Varnished door and frame	Below	No	Wood	1 door and 15 SF
DC	Interior	Classroom	212	Baseboard	Below	No	Wood	50 SF
DD	Interior	Classroom	212	Radiator	Below	No	Metal	10 SF
DE	Interior	Classroom	212	Chalkboard perimeters	Below	No	Wood	10 SF
DF	Interior	Classroom	210	Varnished door and frame	Below	No	Wood	1 door and 15 SF
DG	Interior	Classroom west wall	210	Baseboard	Below	No	Wood	5 SF
DH	Interior	Storage room	255	Varnish door	Below	No	Wood	1 door
DI	Interior	Storage room	255	Painted ladder	Above/Below	No	Metal	10 SF
DJ	Interior	Storage room	255	Painted access hatch	Above	No	Wood	5 SF
DK	Interior	Staff restroom, west wall	213	Walls	Above/Below	No	Plaster	60 SF
DL	Interior	Girls restroom	211	Varnish door and frame	Below	No	Wood	2 doors and 20 SF
DM	Interior	Custodial closet	2C2	Varnished door frame	Below	No	Wood	15 SF
DN	Interior	Storage closet	254	Varnished built-in cabinets	Below	No	Wood	50 SF
DO	Interior	Boys restroom	207	Varnish door and frame	Below	Yes	Wood	2 doors and 20 SF

ID	Interior / Exterior	Location	Room Name/ #	Structure	Above / Below five feet	K-2nd Grade	Substrate	Quantity
DP	Interior	Boys restroom	207	Sink divider	Below	Yes	Metal	25 SF
DQ	Interior	Storage room	253	Varnish door and frame	Below	Yes	Wood	1 door and 15 SF
DR	Interior	Storage room	253	Varnished built-in cabinets	Below	No	Wood	50 SF
DS	Interior	Boys restroom	205	Ceilings	Above	Yes	Plaster	15 SF
DT	Interior	Storage room	2C1	Varnished door frame	Below	No	Wood	15 SF
DU	Interior	Storage room	2C1	Varnished door frame	Below	No	Wood	30 SF
DV	Interior	Girls restroom	203	Northeast wall	Below	Yes	Plaster	10 SF
DX	Interior	Girls restroom	203	Ceilings	Above	Yes	Plaster	10 SF
DY	Interior	Storage room	251	Varnish door	Below	No	Wood	1 door
DZ	Interior	Storage room	251	North wall	Above/Below	No	Plaster	20 SF
EA	Interior	Classroom	P3	Door and door frame	Below	Yes	Metal	1 door and 15 SF
EB	Interior	Classroom	P3	Door well	Above	Yes	Gypsum	5 SF
EC	Interior	Classroom	P4	Support post	Below	Yes	Wood	10 SF
ED	Interior	Classroom	P2	West door	Below	Yes	Wood	1 door
EE	Interior	Classroom	P2	Varnished cabinets	Below	Yes	Wood	60 SF
EF	Interior	Classroom	P1	Varnished doors	Below	Yes	Wood	2 doors
EG	Interior	Classroom	P1	Varnished cabinets and cupboards	Above/Below	Yes	Wood	60 SF
EH	Interior	Classroom	P1	Varnished cubbies	Below	Yes	Wood	40 SF
EI	Interior	A-wing, north hallway	N/A	Door and door frame	Below	Yes	Wood	1 door and 15 SF
EJ	Interior	Classroom by door	A4	Wall	Below	Yes	Gypsum	5 SF
EK	Interior	Classroom	A4	Sink cabinets	Below	Yes	Wood	5 SF
EL	Interior	Classroom	A5	Window sill	Below	Yes	Wood	20 SF
EM	Interior	Classroom	A5	Lower cabinets	Below	Yes	Wood	15 SF
EN	Interior	Classroom	A3	Door varnish	Below	Yes	Wood	1 door

ID	Interior / Exterior	Location	Room Name/ #	Structure	Above / Below five feet	K-2nd Grade	Substrate	Quantity
EO	Interior	Classroom	A3	Window sill and associated cupboards	Below	Yes	Wood	100 SF
EP	Interior	Classroom	A2	Varnished sink cabinets	Below	Yes	Wood	10 SF
EQ	Interior	Mechanical room	N/A	Varnished door and frame	Below	No	Wood	1 door and 15 SF
ER	Interior	Mechanical room	N/A	Wall	Below	No	Gypsum	150 SF
ES	Interior	Mechanical room	N/A	Duct	Above	No	Metal	50 SF
ET	Interior	Girls restroom	N/A	Door frame	Below	Yes	Wood	15 SF
EU	Interior	Classroom	A8	Varnished lower sink cabinets	Below	Yes	Wood	15 SF
EV	Interior	Classroom	A1	Varnished door	Below	Yes	Wood	1 door
EW	Interior	Classroom	A1	Window sill and associated cupboards	Below	Yes	Wood	75 SF
EX	Interior	Classroom storage	AS-1	Cabinets	Below	No	Wood	75 SF
EY	Interior	Classroom	A9	Cabinets	Below	Yes	Wood	20 SF
EZ	Interior	Classroom	A9	East window frame, sills and cupboards	Below	Yes	Wood	150 SF
FA	Interior	Classroom	A9	Coat hanger area	Below	Yes	Wood	40 SF
FB	Interior	Classroom	A11	Sink area cabinets	Below	Yes	Wood	10 SF
FC	Interior	Classroom	A11	Window sills	Below	Yes	Wood	10 SF
FD	Interior	South a-hall east side	CC	Exterior doors	Below	Yes	Metal	2 door
FE	Interior	Classroom	A12	Painted window sills	Below	Yes	Wood	10 SF
FF	Interior	Girls restroom A-wing south hall	N/A	Painted north wall	Above	Yes	Plaster	10 SF
FG	Interior	A-wing south hall janitors storage	N/A	Varnished door and frame	Below	No	Wood	1 door and 15 SF
FH	Interior	A-wing south hall janitors closet	N/A	Ceilings	Above	No	Plaster	10 SF
FI	Interior	Classroom	A13	Door and door frame	Below	Yes	Wood	1 door and 15 SF

Beach Elementary School 1710 N Humboldt Street 97217 Facility Plan

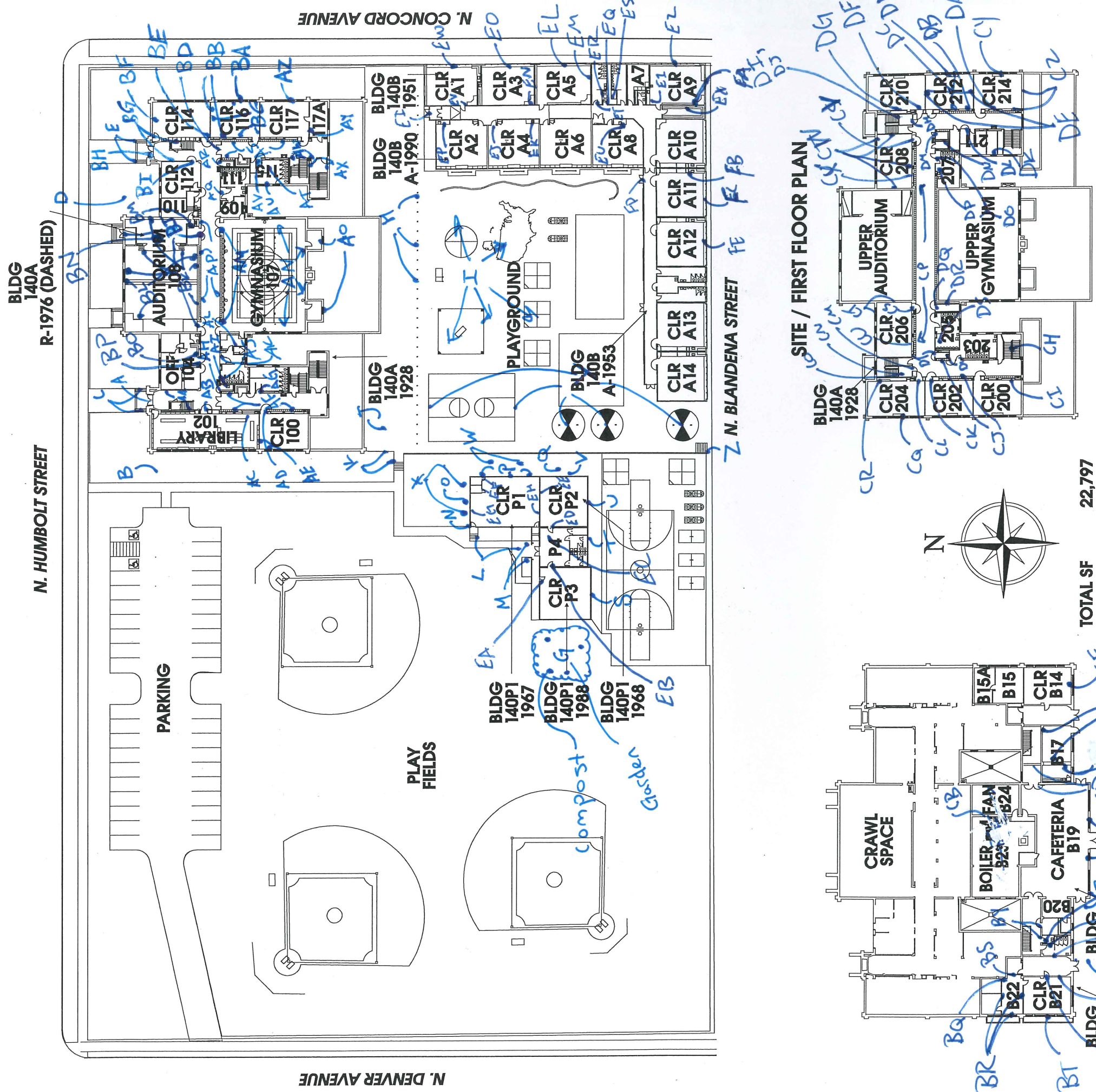

SITE / FIRST FLOOR PLAN

SECOND FLOOR PLAN

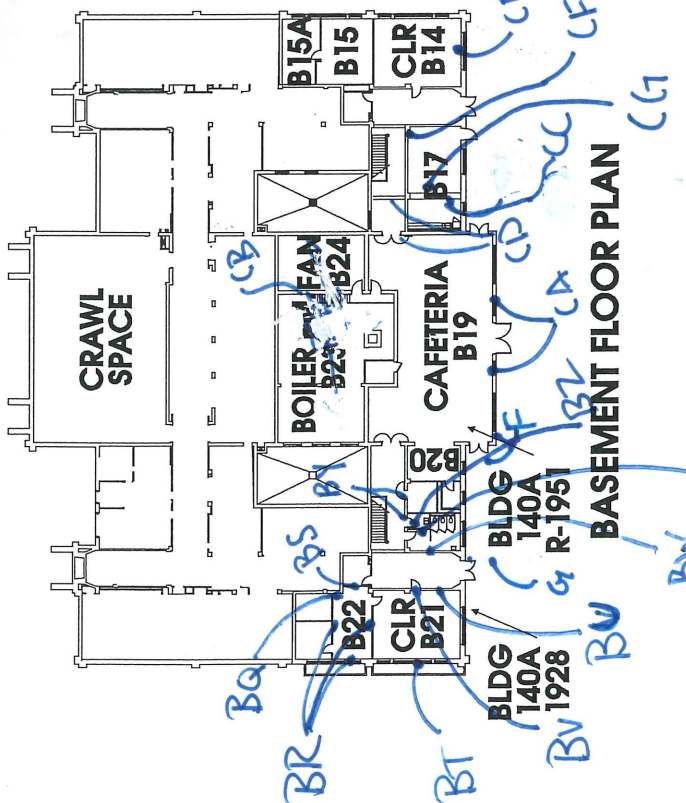

BASEMENT FLOOR PLAN

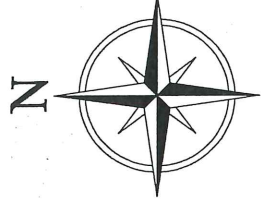

TOTAL SF	22,797
ACRES	5.31
1/4 SECT.	2528

June 9, 2016

Steven J. Dilling
PBS Engineering and Environmental Inc.
4412 SW Corbett Ave
Portland, OR 97239

800 NE Oregon Street, Suite 640
Portland, OR 97232
Phone: (971) 673-0440
Fax: (971) 673-0457
TTY Nonvoice: (971) 673-0372

RE: LEAD-BASED PAINT ACTIVITIES, INDIVIDUAL CERTIFICATION NO. 1063--Indv--R

This letter is your official notification that you have met the certification requirements under Oregon Administrative Rule (OAR) 333-069 to conduct lead-based paint activities in Oregon, in the following discipline: Risk Assessor

In addition to certification by the Oregon Health Authority, you are required to be licensed by the Construction Contractors Board (CCB) if you plan to conduct lead-based paint activities in Oregon. This license is different than, and in addition to, the standard contractor license issued by CCB. Both individuals and firms must obtain this license. For more information on CCB lead-based paint licensing, visit their web site at www.oregon.gov/CCB or call 503-378-4621.

As a certified individual in Oregon, you must meet all the requirements of OAR 333-069, including work practice standards for conducting lead-based paint activities in target housing and child-occupied facilities. As a certified individual, you must perform work under a firm that is certified by the Authority for conducting lead-based paint activities.

You are required to wear the enclosed badge in plain view when conducting lead-based paint activities. Please note that the badge and certificate will expire on 6/30/2017. If you wish to maintain your certification after 6/30/2017, you must submit an application postmarked at least 60 days before expiration and document that your lead-based paint activities training is current.

As a public service the Authority publishes a list of individuals performing lead-based paint activities in Oregon. The list is distributed statewide to consumers interested in lead-based paint services. Individuals that are certified by the state are eligible to be on this list.

If you have any questions concerning your certification or other aspects of the Lead-Based Paint Program, please contact program staff at 971-673-0440.

Sincerely,



Ben Maynard
Lead-Based Paint Program
Oregon Health Authority

Enclosures: 1) Badge; 2) Certificate

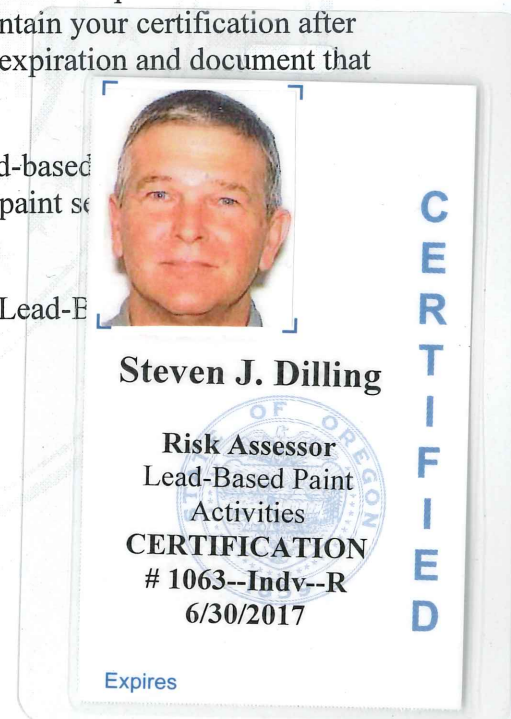

State of Oregon
Oregon Health Authority

Steven J. Dilling

is certified by the Oregon Health Authority to conduct Lead-Based Paint Activities

Risk Assessor

Certification Number:	1063--Indv--R
Issuance Date:	6/9/2016
Expiration Date:	6/30/2017

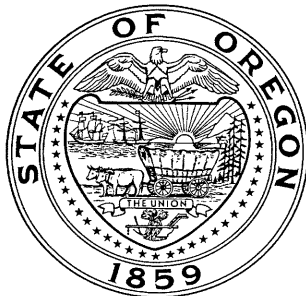

Oregon
Health
Authority

STEVEN JAY DILLING
4412 SW CORBETT AVE
PORTLAND, OR 97239

**CONSTRUCTION CONTRACTORS BOARD
LEAD BASED PAINT
RISK ASSESSOR LICENSE**

EXPIRATION DATE: 7/31/2017

This document certifies that

STEVEN JAY DILLING
4412 SW CORBETT AVE
PORTLAND, OR 97239

is licensed in accordance with Oregon Law as
a Lead Based Paint Risk Assessor.

9151063-RA

**STATE OF OREGON
CONSTRUCTION CONTRACTORS BOARD
LEAD BASED PAINT
RISK ASSESSOR LICENSE**

LICENSE NUMBER: 9151063-RA

This document certifies that:

STEVEN JAY DILLING
4412 SW CORBETT AVE
PORTLAND, OR 97239

is licensed in accordance with Oregon Law as a Lead Based Paint Risk Assessor.

License Details:

LICENSE NO.: 9151063-RA
EXPIRATION DATE: 7/31/2017

May 17, 2016

PBS Engineering and Environmental Inc.
4412 SW Corbett Ave
Portland, OR 97239

800 NE Oregon Street, Suite 640
Portland, OR 97232
Phone: (971) 673-0440
Fax: (971) 673-0457
TTY Nonvoice: (971) 673-0372

Attention: Derek May

RE: LEAD-BASED PAINT ACTIVITIES, FIRM CERTIFICATION NO. 1038--LBP FIRM

This letter is your official notification that PBS Engineering and Environmental Inc. has met certification requirements under Oregon Administrative Rules (OAR) 333-069 to conduct lead-based paint activities in Oregon. Please note that the enclosed certificate will expire on 6/30/2017.

In addition to certification by the Oregon Health Authority (Authority), PBS Engineering and Environmental Inc. is required to be licensed by the Construction Contractors Board (CCB) prior to conducting lead-based paint activities in Oregon. This license is different than, and in addition to, the standard contractor license issued by CCB. Both individuals and firms must obtain this license. For more information on CCB lead paint licensing, visit their web site at www.oregon.gov/CCB or call 503-378-4621.

As a firm certified to conduct lead-based paint inspection activities in Oregon, PBS Engineering and Environmental Inc. must meet all requirements set forth in OAR 333-069. It must comply with standards for conducting lead-based paint inspection and/or risk assessment activities in target housing and child-occupied facilities and employ only certified individuals to conduct regulated activities.

As a public service, the Authority publishes a list of firms performing lead-based paint activities in Oregon. The list is distributed statewide to consumers interested in lead-based paint services. Only those firms that are certified by the state are eligible to be on this list.

If you have any questions concerning this certification or other aspects of the Lead-Based Paint Program, please contact program staff at (971) 673-0440.

Sincerely,

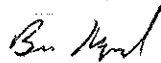

Ben Maynard
Lead-Based Paint Program
Oregon Health Authority

This document can be obtained in an alternate format by calling: (971) 673-0440.

State of Oregon
Oregon Health Authority

PBS Engineering and Environmental Inc.

is certified by the Oregon Health Authority to conduct Lead-Based Paint Activities

Certification Number:	1038--LBP FIRM
Issuance Date:	5/16/2016
Date of Expiration:	6/30/2017

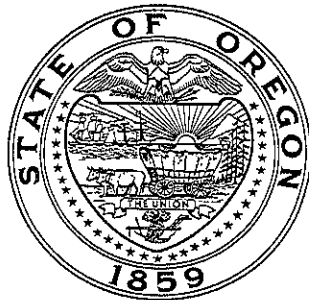

Oregon
Health
Authority

PBS ENGINEERING & ENVIRONMENTAL INC
4412 SW CORBETT
PORTLAND OR 97239

CONSTRUCTION CONTRACTORS BOARD
LEAD INSPECTION CONTRACTORS LICENSE
LICENSE No.: LBPI129143
EXPIRATION DATE: 7/31/2017

This document certifies that

PBS ENGINEERING & ENVIRONMENTAL INC
4412 SW CORBETT
PORTLAND OR 97239

is licensed in accordance with Oregon Law as
a Lead Inspection Contractor.

STATE OF OREGON
CONSTRUCTION CONTRACTORS BOARD
LEAD INSPECTION CONTRACTORS LICENSE

LICENSE NUMBER: LBPI129143

This document certifies that:

PBS ENGINEERING & ENVIRONMENTAL INC
4412 SW CORBETT
PORTLAND OR 97239

is licensed in accordance with Oregon Law as a Lead Inspection Contractor.

License Details:

LBPI LICENSE NO.: LBPI129143
EXPIRATION DATE: 7/31/2017