



April 19, 2017

Courtney Wilton
Portland Public Schools
501 North Dixon
Portland, Oregon 97227

Via email: cwilton@pps.net

Regarding: Lead Paint Condition Assessment
Sacajawea Head Start School
4800 NE 74th Avenue
Portland, Oregon 97218
PBS Project: 6500.721 Phase 0081

Dear Mr. Wilton:

On March 15, 2017, PBS Engineering and Environmental Inc. (PBS) conducted a visual inspection and assessment of painted and varnished surfaces on the interior and exterior of Sacajawea Head Start school located at 4800 NE 74th Avenue in Portland, Oregon.

PBS assessed painted and varnished interior and exterior hard surfaces as well as concrete, asphalt, soil, garden spaces, playground equipment, and windowsills adjacent or in close proximity to deteriorated painted or varnished surfaces.

Paint and varnish conditions were assessed using US Department of Housing and Urban Development (HUD) guidelines for the Evaluation and Control of Lead Based Paint Hazards in Housing (2012 Addition) Chapter 5: Risk Assessment and Reevaluation.

It is assumed that all paint and varnish at the school contain some concentration of lead. The purpose of this investigation is to identify those finishes in deteriorated condition.

FINDINGS

Overall, the building's painted and varnished surfaces were found to be in intact condition with areas of fair and deteriorated conditions. A table listing the locations and quantity of surfaces in deteriorated condition is attached to this report.

No paint chips were observed in the school's garden; however, paint chips were observed in soil on the south exterior of the building from playroom 113 to office 112. Paint chips were also observed on the floor in the boiler room.

The school's windows are wood push-out. Troughs were observed to be dirty and paint chips were noted.

Painted playground and parking lot striping and curbing often contain lead and are generally in deteriorated condition due to weatherization and traffic. PBS did not assess this paint, but recommends restriping, as needed, to maintain in intact condition.

RECOMMENDATIONS

PBS recommends that all painted or varnished surfaces in deteriorated condition noted on the attached table be stabilized. All paint chips noted in this report should be removed, including those observed in window troughs.

Please feel free to contact me at 503.417.7691 or clark@pbsenv.com with any questions or comments.

Sincerely,

Clark Nelson, CIH
Senior Project Manager

Attachments: Condition Assessment of Deteriorated Paint/Varnish Table
Field Drawing of Deteriorated Paint and Varnish Locations
Lead-based Paint Risk Assessor Certification (Clark Nelson)
Lead-based Paint Activities Firm Certification (PBS Engineering and Environmental)

CN:DM:bmp

Sacajawea Head Start School
Assessment of Paint/Varnish in Deteriorated Condition

| ID | Interior / Exterior | Location | Structure | Above / Below five feet | K-2nd Grade | Substrate | Square Feet |
|----|---------------------|-------------------------------|---------------------------------|-------------------------|-------------|-----------|-------------|
| A | Interior | Play room 113 | Southwest corner wall | Below | No | Plaster | 10 |
| B | Interior | Kitchen | Double doors and frames | Above and below | No | Wood | 60 |
| C | Interior | Kitchen, dry storage | Doorframe | Above and below | No | Wood | 15 |
| D | Interior | Kitchen | Built-in cabinets under sink | Below | No | Wood | 20 |
| E | Interior | Custodial next to boiler room | Southwest corner wall | Below | No | Wood | 40 |
| F | Interior | Custodial next to boiler room | Floor | Below | No | Concrete | 160 |
| G | Interior | Custodial next to boiler room | Paint chips on floor | Below | No | N/A | 2 |
| H | Interior | Classroom 107 | Chalkboard rail on west wall | Below | Yes | Wood | 10 |
| I | Interior | Classroom 108 | Chalkboard rail on east wall | Below | Yes | Wood | 10 |
| J | Interior | RES Center 109 | Chalkboard rail on west wall | Below | No | Wood | 10 |
| K | Interior | Custodial next to room 111 | Floor | Below | No | Concrete | 80 |
| L | Interior | Custodial next to room 111 | Built-in cabinets | Below | No | Wood | 30 |
| M | Interior | Custodial next to room 111 | Doorframe | Above and below | No | Wood | 15 |
| N | Interior | Copier room 11 | Built-in cabinets | Below | No | Wood | 80 |
| O | Interior | Classroom 103 | Doorframe | Above and below | Yes | Wood | 15 |
| P | Interior | Classroom 101 | Doorframe | Above and below | Yes | Wood | 15 |
| Q | Interior | Classroom 100 | Windowsill | Above | No | Wood | 5 |
| R | Interior | Classroom 100 bathroom | West exterior door and frame | Above and below | No | Metal | 60 |
| S | Interior | Boiler room | East exterior door and frame | Above and below | No | Metal | 60 |
| T | Interior | Boiler room | Wall next to east exterior door | Below | No | Plaster | 10 |
| U | Interior | Boiler room | Paint chips on floor | Below | No | N/A | 3 |
| V | Interior | Boiler room | Southeast corner wall | N/A | No | N/A | 15 |

| ID | Interior / Exterior | Location | Structure | Above / Below five feet | K-2nd Grade | Substrate | Square Feet |
|----|---------------------|-----------------------------------|---------------------------------|-------------------------|-------------|-----------|-------------|
| W | Interior | Boiler room | Paint chips on floor | Below | No | N/A | 2 |
| X | Interior | Boiler room | HVAC housing | Above and below | No | Metal | 60 |
| Y | Interior | Boiler room | Windowsills | Below | No | Concrete | 20 |
| Z | Interior | Boiler room | Boiler tank supports | Above and below | No | Metal | 80 |
| AA | Exterior | South exterior of play room 113 | Wall next to east exterior door | Above and below | No | Wood | 60 |
| AB | Exterior | South exterior of play room 113 | Paint chips in soil | Below | No | N/A | 10 |
| AC | Exterior | South exterior of building | Paint chips in soil | Below | No | N/A | 300 |
| AD | Exterior | RES center 109 | Underside of roof overhang | Above | No | Wood | 20 |
| AE | Exterior | Northeast building entrance | Underside of roof hang-beams | Above | No | Wood | 30 |
| AF | Exterior | Classroom 105 | Underside of roof overhand | Above | No | Wood | 20 |
| AG | Exterior | Northeast exterior of boiler room | Underside of roof overhand | Above | No | Wood | 30 |

**Sacajawea Head Start
4800 NE 74th Avenue 97218
Facility Plan**

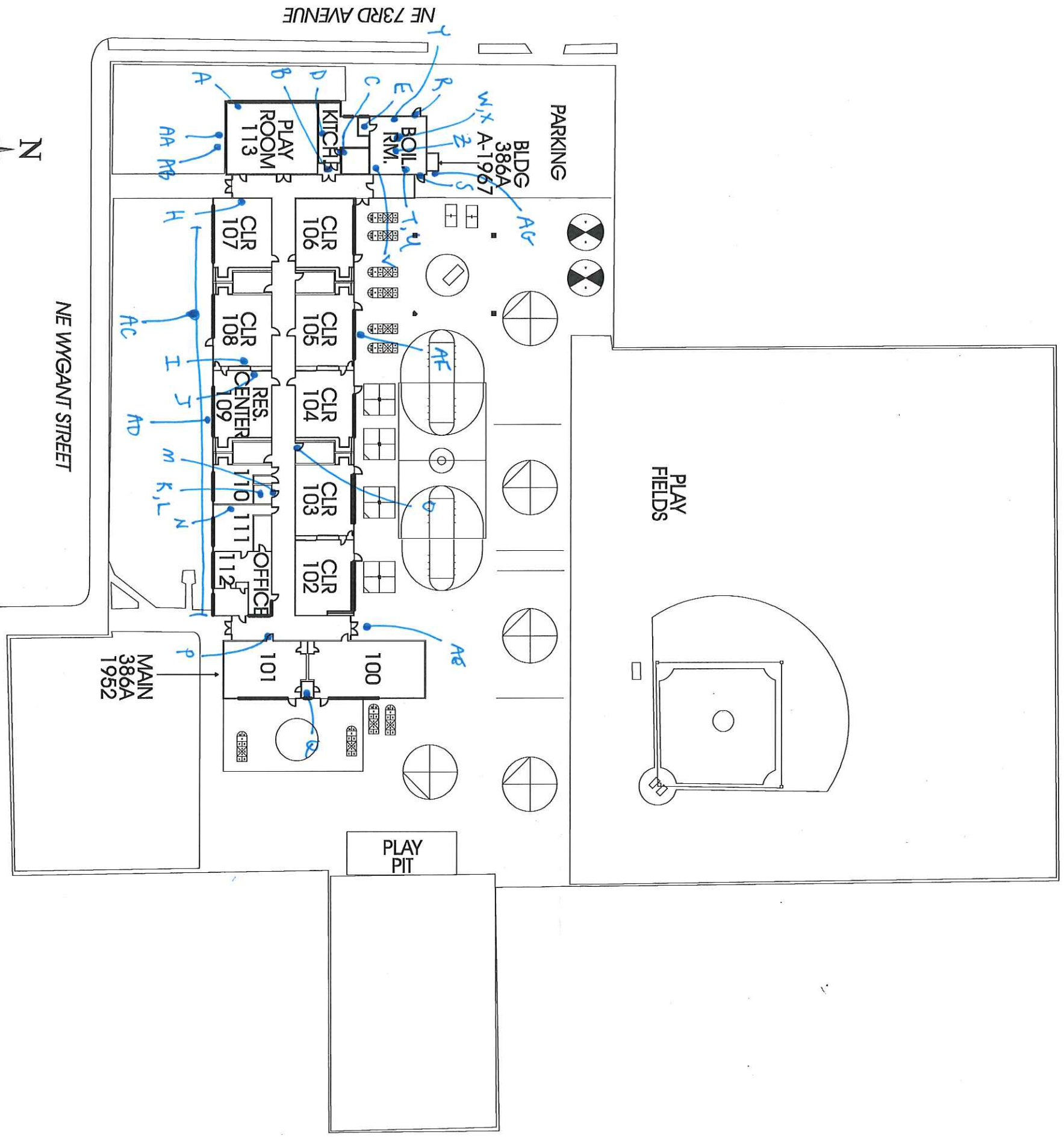

SITE / FIRST FLOOR PLAN

TOTAL SF 18,751
ACRES 3.87
1/4 SECT. 2538

June 9, 2016

Clark R. Nelson
PBS Engineering and Environmental Inc.
4412 S.W. Corbett Ave
Portland, OR 97239

800 NE Oregon Street, Suite 640
Portland, OR 97232
Phone: (971) 673-0440
Fax: (971) 673-0457
TTY Nonvoice: (971) 673-0372

RE: LEAD-BASED PAINT ACTIVITIES, INDIVIDUAL CERTIFICATION NO. 1806--Indv--R

This letter is your official notification that you have met the certification requirements under Oregon Administrative Rule (OAR) 333-069 to conduct lead-based paint activities in Oregon, in the following disciplines: Risk Assessor; Inspector

In addition to certification by the Oregon Health Authority, you are required to be licensed by the Construction Contractors Board (CCB) if you plan to conduct lead-based paint activities in Oregon. This license is different than, and in addition to, the standard contractor license issued by CCB. Both individuals and firms must obtain this license. For more information on CCB lead-based paint licensing, visit their web site at www.oregon.gov/CCB or call 503-378-4621.

As a certified individual in Oregon, you must meet all the requirements of OAR 333-069, including work practice standards for conducting lead-based paint activities in target housing and child-occupied facilities. As a certified individual, you must perform work under a firm that is certified by the Authority for conducting lead-based paint activities.

You are required to wear the enclosed badge in plain view when conducting lead-based paint activities. Please note that the badge and certificate will expire on 6/30/2017. If you wish to maintain your certification after 6/30/2017, you must submit an application postmarked at least 60 days before expiration and document that your lead-based paint activities training is current.

As a public service the Authority publishes a list of individuals performing lead-based paint activities in Oregon. The list is distributed statewide to consumers interested in lead-based paint activities. Individuals that are certified by the state are eligible to be on this list.

If you have any questions concerning your certification or other aspects of the Lead-Based Paint Program, please contact program staff at 971-673-0440.

Sincerely,

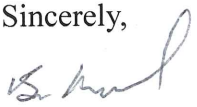
Ben Maynard
Lead-Based Paint Program
Oregon Health Authority

Enclosures: 1) Badge; 2) Certificate



Clark R. Nelson

**Risk Assessor
Inspector
Lead-Based Paint
Activities
CERTIFICATION
1806--Indv--R
6/30/2017**

Expires

CERTIFIED

State of Oregon
Oregon Health Authority

Clark R. Nelson

is certified by the Oregon Health Authority to conduct Lead-Based Paint Activities

Risk Assessor

| | |
|-----------------------|---------------|
| Certification Number: | 1806--Indv--R |
| Issuance Date: | 6/9/2016 |
| Expiration Date: | 6/30/2017 |

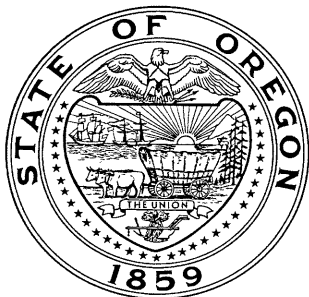

Oregon
Health
Authority

CLARK RICHARD NELSON
4412 SW CORBETT AVE
PORTLAND, OR 97239

**CONSTRUCTION CONTRACTORS BOARD
LEAD BASED PAINT
RISK ASSESSOR LICENSE**

EXPIRATION DATE: 6/24/2017

This document certifies that

CLARK RICHARD NELSON
4412 SW CORBETT AVE
PORTLAND, OR 97239

is licensed in accordance with Oregon Law as
a Lead Based Paint Risk Assessor.

9151806-RA

**STATE OF OREGON
CONSTRUCTION CONTRACTORS BOARD
LEAD BASED PAINT
RISK ASSESSOR LICENSE**

LICENSE NUMBER: 9151806-RA

This document certifies that:

CLARK RICHARD NELSON
4412 SW CORBETT AVE
PORTLAND, OR 97239

is licensed in accordance with Oregon Law as a Lead Based Paint Risk Assessor.

License Details:

LICENSE NO.: 9151806-RA
EXPIRATION DATE: 6/24/2017

May 17, 2016

PBS Engineering and Environmental Inc.
4412 SW Corbett Ave
Portland, OR 97239

800 NE Oregon Street, Suite 640
Portland, OR 97232
Phone: (971) 673-0440
Fax: (971) 673-0457
TTY Nonvoice: (971) 673-0372

Attention: Derek May

RE: LEAD-BASED PAINT ACTIVITIES, FIRM CERTIFICATION NO. 1038--LBP FIRM

This letter is your official notification that PBS Engineering and Environmental Inc. has met certification requirements under Oregon Administrative Rules (OAR) 333-069 to conduct lead-based paint activities in Oregon. Please note that the enclosed certificate will expire on 6/30/2017.

In addition to certification by the Oregon Health Authority (Authority), PBS Engineering and Environmental Inc. is required to be licensed by the Construction Contractors Board (CCB) prior to conducting lead-based paint activities in Oregon. This license is different than, and in addition to, the standard contractor license issued by CCB. Both individuals and firms must obtain this license. For more information on CCB lead paint licensing, visit their web site at www.oregon.gov/CCB or call 503-378-4621.

As a firm certified to conduct lead-based paint inspection activities in Oregon, PBS Engineering and Environmental Inc. must meet all requirements set forth in OAR 333-069. It must comply with standards for conducting lead-based paint inspection and/or risk assessment activities in target housing and child-occupied facilities and employ only certified individuals to conduct regulated activities.

As a public service, the Authority publishes a list of firms performing lead-based paint activities in Oregon. The list is distributed statewide to consumers interested in lead-based paint services. Only those firms that are certified by the state are eligible to be on this list.

If you have any questions concerning this certification or other aspects of the Lead-Based Paint Program, please contact program staff at (971) 673-0440.

Sincerely,



Ben Maynard
Lead-Based Paint Program
Oregon Health Authority

This document can be obtained in an alternate format by calling: (971) 673-0440.

State of Oregon
Oregon Health Authority

PBS Engineering and Environmental Inc.

is certified by the Oregon Health Authority to conduct Lead-Based Paint Activities

| | |
|-----------------------|----------------|
| Certification Number: | 1038--LBP FIRM |
| Issuance Date: | 5/16/2016 |
| Date of Expiration: | 6/30/2017 |



Oregon
Health
Authority

PBS ENGINEERING & ENVIRONMENTAL INC
4412 SW CORBETT
PORTLAND OR 97239

CONSTRUCTION CONTRACTORS BOARD
LEAD INSPECTION CONTRACTORS LICENSE
LICENSE No.: LBPI129143
EXPIRATION DATE: 7/31/2017

This document certifies that

PBS ENGINEERING & ENVIRONMENTAL INC
4412 SW CORBETT
PORTLAND OR 97239

is licensed in accordance with Oregon Law as
a Lead Inspection Contractor.

STATE OF OREGON
CONSTRUCTION CONTRACTORS BOARD
LEAD INSPECTION CONTRACTORS LICENSE

LICENSE NUMBER: LBPI129143

This document certifies that:

PBS ENGINEERING & ENVIRONMENTAL INC
4412 SW CORBETT
PORTLAND OR 97239

is licensed in accordance with Oregon Law as a Lead Inspection Contractor.

License Details:

LBPI LICENSE NO.: LBPI129143
EXPIRATION DATE: 7/31/2017