



April 20, 2017

Courtney Wilton  
Portland Public Schools  
501 North Dixon  
Portland, Oregon 97227

Via email: cwilton@pps.net

Regarding: Lead Paint Condition Assessment  
Wilson High School  
1151 SW Vermont Street  
Portland, Oregon 97219  
PBS Project: 6500.721 Phase 0085

Dear Mr. Wilton:

On April 11, 2017, PBS Engineering and Environmental Inc. (PBS) conducted a visual inspection and assessment of painted and varnished surfaces on the interior and exterior of Wilson High School located at 1151 SW Vermont Street in Portland, Oregon.

PBS assessed painted and varnished interior and exterior hard surfaces as well as concrete, asphalt, soil, garden spaces, compost piles, and windowsills adjacent or in close proximity to deteriorated painted or varnished surfaces.

Paint and varnish conditions were assessed using US Department of Housing and Urban Development (HUD) guidelines for the Evaluation and Control of Lead Based Paint Hazards in Housing (2012 Addition) Chapter 5: Risk Assessment and Reevaluation.

It is assumed that all paint and varnish at the school contain some concentration of lead. The purpose of this investigation is to identify those finishes in deteriorated condition.

## **FINDINGS**

Overall, the building's painted and varnished surfaces were found to be in intact condition with areas of fair and deteriorated conditions. A table listing the locations and quantity of surfaces in deteriorated condition is attached to this report.

No paint chips were observed in the school's garden or compost pile; however, paint chips were observed in soil on the east and south exteriors of the photographic arts room, and on exterior concrete outside faculty 145 and the north side of the gym. Paint chips were also observed on the floor inside custodial room 211.

The school's metal pull-in windows displayed no signs of abrasion, and no paint chips were noted.

Painted playground and parking lot striping and curbing often contain lead and are generally in deteriorated condition due to weatherization and traffic. PBS did not assess this paint, but recommends restriping, as needed, to maintain in intact condition.

### **RECOMMENDATIONS**

PBS recommends that all painted or varnished surfaces in deteriorated condition noted on the attached table be stabilized. All paint chips noted in this report should be removed.

Please feel free to contact me at 503.417.7691 or [clark@pbsenv.com](mailto:clark@pbsenv.com) with any questions or comments.

Sincerely,

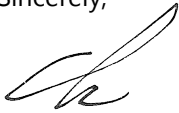

Clark Nelson, CIH  
Senior Project Manager

Attachments: Condition Assessment of Deteriorated Paint/Varnish Table  
Field Drawing of Deteriorated Paint and Varnish Locations  
Lead-based Paint Risk Assessor Certification (Clark Nelson)  
Lead-based Paint Activities Firm Certification (PBS Engineering and Environmental)

CN:DM:bmp

**Wilson High School**  
**Assessment of Paint/Varnish in Deteriorated Condition**

ID	Interior / Exterior	Location	Structure	Above / Below five feet	K-2nd Grade	Substrate	Square Feet
A	Exterior	Faculty 145	Wall under windows (paint chips)	Below	No	Concrete	20
B	Exterior	West building entrance near faculty 145	Handrails	Below	No	Metal	20
C	Exterior	West building entrance near faculty 145	Posts	Below	No	Metal	15
D	Exterior	Southwest gym entrance	Handrails and posts	Below	No	Metal	20
E	Exterior	South side of pool area	Wall	Above and below	No	Concrete	160
F	Exterior	Press box east door frame	Door frame	Above and below	No	Metal	15
G	Exterior	Northeast corner of pool area	Wall and handrail	Above and below	No	Concrete and metal	150
H	Exterior	North gym entrance	Posts	Below	No	Concrete	10
I	Exterior	North gym exterior	Wall (paint chips)	Below	No	Concrete	50
J	Exterior	North building entrance	Wall under brick	Below	No	Concrete	40
K	Exterior	East exterior of boiler room	Wall under brick	Below	No	Concrete	40
L	Exterior	Loading dock	Walls and handrails	Below	No	Concrete and metal	200
M	Exterior	Vestibule	Guard rail supports and ceiling trim	Above and below	No	Concrete and metal	90
N	Exterior	Entrance near classroom 29	Supports	Above and below	No	Metal	20
O	Exterior	Entrance to room north of cafeteria	Posts	Below	No	Metal	10
P	Exterior	East exterior of drafting/photographic arts	Wall (paint chips) and trim	Below	No	Concrete	100
Q	Exterior	South exterior of drafting/photographic arts	Wall and trim (paint chips)	Below	No	Concrete	80
R	Exterior	Building entrance near photo arts	Supports	Above and below	No	Metal	20
S	Exterior	Southeast auditorium entrance	Wall	Below	No	Concrete	60
T	Exterior	Baseball field	Underside of bleachers	Above and below	No	Metal	800
U	Exterior	Baseball field	Press box window assemblies	Above and below	No	Wood	25
V	Exterior	Baseball field	Northeast dugout trim	Above	No	Wood	40

ID	Interior / Exterior	Location	Structure	Above / Below five feet	K-2nd Grade	Substrate	Square Feet
W	Exterior	Baseball field	Southwest dugout trim	Above	No	Wood	40
X	Exterior	Baseball field	Concessions door	Above and below	No	Metal	45
Y	Exterior	Home grandstand	Handrails around track	Below	No	Metal	200
Z	Interior	Boiler room	Handrails and cat walk	Above and below	No	Metal	300
AA	Interior	Boiler room	Tank doors	Above and below	No	Metal	90
AB	Interior	Custodial lunch room	Floor	Below	No	Concrete	350
AC	Interior	Custodial lunch room	Built-in cabinets	Above and below	No	Wood	80
AD	Interior	Boiler custodial	Floor	Below	No	Concrete	220
AE	Interior	Boiler custodial	Pipes	Above and below	No	Metal	40
AF	Interior	Custodial	Door	Above and below	No	Wood	45
AG	Interior	Custodial	Door	Above and below	No	Wood	45
AH	Interior	Boy's restroom 23	Door and frame	Above and below	No	Wood	60
AI	Interior	Kitchen	East serving line doors	Above and below	No	Wood	90
AJ	Interior	Kitchen food storage	Door and frame	Above and below	No	Wood	60
AK	Interior	Kitchen office door	Door	Above and below	No	Wood	45
AL	Interior	Cafeteria	South dish return door frame	Above and below	No	Wood	15
AM	Interior	Mechanical room south of cafeteria	Doors	Above and below	No	Wood	90
AN	Interior	Metal 15	Doors	Above and below	No	Wood	225
AO	Interior	Wood work 9	Doors	Above and below	No	Wood	315
AP	Interior	Wood work 9	Wall nest to south entrance	Above and below	No	Concrete	25
AQ	Interior	Custodial 10	Door	Above and below	No	Wood	45
AR	Interior	Drafting 8	Built-in cabinets	Above and below	No	Wood	85
AS	Interior	Robotics	Door	Above and below	No	Wood	45

ID	Interior / Exterior	Location	Structure	Above / Below five feet	K-2nd Grade	Substrate	Square Feet
AT	Interior	Faculty men 4	Door	Above and below	No	Wood	45
AU	Interior	Industrial education lab	Door	Above and below	No	Wood	45
AV	Interior	Office work room	Built-in cabinets	Below	No	Wood	20
AW	Interior	Stage entrance by office	Door	Above and below	No	Wood	90
AX	Interior	Vice principals work room	Floor	Below	No	Concrete	100
AY	Interior	East gym entrance	Door	Above and below	No	Wood	360
AZ	Interior	Stairwell to roof east of gym	Walls	Above and below	No	Concrete	160
BA	Interior	Sprinkler room across from 2nd floor elevator	Walls	Above and below	No	Concrete	80
BB	Interior	Boy's room 231	Door	Above and below	No	Wood	90
BC	Interior	Custodial 230	Door	Above and below	No	Wood	45
BD	Interior	Girl's room 228	Doors	Above and below	No	Wood	90
BE	Interior	Classroom 227	Door	Above and below	No	Wood	45
BF	Interior	Textbook drop 243	Door	Above and below	No	Wood	45
BG	Interior	Library 244	Doors	Above and below	No	Wood	90
BH	Interior	Crafts 248	Built-in cabinets	Above and below	No	Wood and concrete	40
BI	Interior	Crafts 248	Door	Above and below	No	Wood	45
BJ	Interior	Classroom 247	Built-in cabinets	Above and below	No	Wood	70
BK	Interior	Classroom 246	Built-in cabinets	Above and below	No	Wood	70
BL	Interior	Classroom 209	Door and frame	Above and below	No	Wood	60
BM	Interior	Classroom 210	Door	Above and below	No	Wood	45
BN	Interior	Classroom 211	Walls (paint chips)	Above and below	No	Concrete	80
BO	Interior	Classroom 213	Door and frame	Above and below	No	Wood	60
BP	Interior	Classroom 214	Built-in cabinets	Above and below	No	Wood	75

ID	Interior / Exterior	Location	Structure	Above / Below five feet	K-2nd Grade	Substrate	Square Feet
BQ	Interior	Classroom 215	Door	Above and below	No	Wood	45
BR	Interior	Boy's room 216	Door	Above and below	No	Wood	45
BS	Interior	Custodial 217	Door	Above and below	No	Wood	45
BT	Interior	Faculty women's 218	Door	Above and below	No	Wood	45
BU	Interior	Classroom 223	Wall near entrance	Below	No	Concrete	25
BV	Interior	Classroom 223	Door	Above and below	No	Wood	45
BW	Interior	Classroom 225	Wall by entrance	Above and below	No	Drywall	35
BX	Interior	Classroom 225	Built-in cabinets	Below	No	Wood	20
BY	Interior	Classroom 226	Built-in cabinets	Above and below	No	Wood	70
BZ	Interior	Classroom 241	Built-in cabinets	Below	No	Wood	160
CA	Interior	Classroom 239	Columns	Above and below	No	Concrete	30
CB	Interior	Classroom 239	Built-in cabinets	Below	No	Wood	100
CC	Interior	Classroom 238	Built-in cabinets	Above and below	No	Concrete	10
CD	Interior	Classroom 238	Door	Below	No	Wood	80
CE	Interior	Classroom 232	Built-in cabinets	Below	No	Wood	140
CF	Interior	Classroom 232	Door	Above and below	No	Wood	45
CG	Interior	Classroom 233	Built-in cabinets	Below	No	Wood	80
CH	Interior	Classroom 233	Wall	Above and below	No	Concrete	20
CI	Interior	Classroom 233	Built-in cabinets	Above and below	No	Wood	120
CJ	Interior	Classroom 235	Built-in cabinets	Below	No	Wood	60
CK	Interior	Classroom 237	Built-in cabinets	Below	No	Wood	100
CL	Interior	Apparatus room	Storage doors	Above and below	No	Wood	90
CM	Interior	Wrestling room	Floor	Below	No	Wood	1500

ID	Interior / Exterior	Location	Structure	Above / Below five feet	K-2nd Grade	Substrate	Square Feet
CN	Interior	Mechanical room by apparatus room	Door frame	Above and below	No	Wood	15
CO	Interior	Classroom 24	Door	Above and below	No	Wood	45
CP	Interior	Classroom 25	East wall	Below	No	Concrete	20
CQ	Interior	Classroom 34	West wall	Above	No	Concrete	30
CR	Interior	Classroom 34	Door	Above and below	No	Wood	45
CS	Interior	Classroom 33	South wall	Below	No	Concrete	25
CT	Interior	Classroom 27	Door and frame	Above and below	No	Wood	60
CU	Interior	Classroom 32	Door and built-in cabinets	Above and below	No	Wood	65
CV	Interior	Classroom 32	Columns	Above and below	No	Concrete	20
CW	Interior	Classroom 32	Vent covers	Below	No	Metal	30
CX	Interior	Classroom 28	Door and built-in cabinets	Above and below	No	Wood	65
CY	Interior	Classroom 31	South wall	Below	No	Concrete	15
CZ	Interior	Classroom 31	Door and built-in cabinets	Above and below	No	Wood	65
DA	Interior	Classroom 30	Far northwest window column plus wall	Above and below	No	Concrete	30
DB	Interior	Classroom 30	West door	Above and below	No	Wood	45
DC	Interior	Classroom 29	North wall	Below	No	Concrete	25
DD	Interior	Classroom 29	Door	Above and below	No	Wood	45
DE	Interior	Classroom 26	Columns	Above and below	No	Concrete	20
DF	Interior	Classroom 26	Vent covers	Below	No	Metal	20
DG	Interior	Classroom 17	East wall	Above	No	Concrete	130
DH	Interior	Classroom 17	Door	Above and below	No	Wood	45
DI	Interior	boys room 125	Doors	Above and below	No	Wood	90
DJ	Interior	Classroom 137	Columns	Above and below	No	Concrete	20

ID	Interior / Exterior	Location	Structure	Above / Below five feet	K-2nd Grade	Substrate	Square Feet
DK	Interior	Classroom 137	Door and built-in cabinets	Above and below	No	Wood	65
DL	Interior	Classroom 127	Door and built-in cabinets	Above and below	No	Wood	65
DM	Interior	Classroom 136	South wall	Below	No	Drywall	20
DN	Interior	Classroom 136	Door	Above and below	No	Wood	45
DO	Interior	Classroom 128	Door	Above and below	No	Wood	45
DP	Interior	Classroom 129	Door and built-in cabinets	Above and below	No	Wood	65
DQ	Interior	Classroom 134	Door and built-in cabinets	Above and below	No	Wood	65
DR	Interior	Classroom 134	South wall	Below	No	Drywall	20
DS	Interior	Classroom 130	Door and built-in cabinets	Above and below	No	Wood	65
DT	Interior	Classroom 133	Door and built-in cabinets	Above and below	No	Wood	65
DU	Interior	Classroom 131	West wall	Below	No	Drywall	5
DV	Interior	Classroom 131	Door	Above and below	No	Wood	45
DW	Interior	Classroom 132	West door	Above and below	No	Wood	45
DX	Interior	Custodial Room 124	Door	Above and below	No	Wood	45
DY	Interior	Girl's Room 122	Doors	Above and below	No	Wood	90
DZ	Interior	Athletic director 121	Doors x3	Above and below	No	Wood	135
EA	Interior	Classroom 120	Door	Above and below	No	Wood	45
EB	Interior	Classroom 119	Door and built-in cabinets	Above and below	No	Wood	75
EC	Interior	Classroom 142	Door and built-in cabinets	Above and below	No	Wood	75
ED	Interior	Classroom 117	Door and built-in cabinets	Above and below	No	Wood	65
EE	Interior	Classroom 143	Door and built-in cabinets	Above and below	No	Wood	65
EF	Interior	Classroom 118	Door and built-in cabinets	Above and below	No	Wood	65
EG	Interior	Classroom 144	Door and built-in cabinets	Above and below	No	Wood	65



ID	Interior / Exterior	Location	Structure	Above / Below five feet	K-2nd Grade	Substrate	Square Feet
EH	Interior	Classroom 116	Door and built-in cabinets	Above and below	No	Wood	65
EI	Interior	Teachers offices 115	Doors	Above and below	No	Wood	135
EJ	Interior	Faculty 145	Door	Above and below	No	Wood	45
EK	Interior	Nurse	Doors	Above and below	No	Wood	90
EL	Interior	Classroom 108	East doors and west	Above and below	No	Wood	180
EM	Interior	Classroom 107	Door and built-in cabinets	Above and below	No	Wood	65
EN	Interior	Classroom 101	Door	Above and below	No	Wood	45
EO	Interior	Classroom 103	Door	Above and below	No	Wood	45
EP	Interior	Band room 104A	North wall built-in cabinets	Above and below	No	Wood	30
EQ	Interior	Band room 104	Door and frame x7	Above and below	No	Wood and metal	420
ER	Interior	Band room 104	Door frame	Above and below	No	Metal	15
ES	Interior	Auditorium foyer	Window columns	Above and below	No	Concrete	40
ET	Interior	Auditorium projection room	Floor	Below	No	Concrete	200
EU	Interior	West auditorium foyer entrance	Doors	Above and below	No	Wood	180
EV	Interior	Southeast gym storage	Duct	Above and below	No	Metal	80
EW	Interior	Southeast gym storage	North wall	Above and below	No	Drywall	40
EX	Interior	Gymnasium	Ceiling	Above	No	Wood	10000
EY	Interior	Boy's locker room from gym	Door and frame	Above and below	No	Wood and metal	60
EZ	Interior	Northwest corner of gym storage	Door and frame	Above and below	No	Wood and metal	60
FA	Interior	Northwest gym stairwell	Handrails	Below	No	Metal	60
FB	Interior	Boy's team Room A	Floor	Below	No	Concrete	300
FC	Interior	Boy's team Room B	Floor	Below	No	Concrete	300
FD	Interior	Boy's team Room C	Door x3	Below	No	Wood and metal	135

ID	Interior / Exterior	Location	Structure	Above / Below five feet	K-2nd Grade	Substrate	Square Feet
FE	Interior	Boy's team Room C	Floor	Below	No	Concrete	500
FF	Interior	Boy's team Room D	Floor	Below	No	Concrete	100
FG	Interior	Boy's locker room	Floor	Below	No	Concrete	2500
FH	Interior	East boy's locker room entrance	Doors	Above and below	No	Metal	90
FI	Interior	Room 38	South wall	Above and below	No	Drywall	80
FJ	Interior	Room 38	Door	Above and below	No	Wood	45
FK	Interior	Apparatus room	Doors	Above and below	No	Wood	90
FL	Interior	Team Room E	Floor	Below	No	Concrete	200
FM	Interior	Girl's locker room custodial	Door	Above and below	No	Wood	45
FN	Interior	Girl's locker room office	Door	Above and below	No	Wood	45
FO	Interior	Girl's locker room north storage	Door	Above and below	No	Wood	45
FP	Interior	Equipment issue girl's locker room	Walls and ceiling	Above and below	No	Drywall	40
FQ	Interior	Girl's locker room south storage	Walls and ceiling	Above and below	No	Drywall	20
FR	Interior	Girl's locker room floor	Floor	Below	No	Concrete	2500

**Wilson High School  
1151 SW Vermont Street 97219  
Facility Plan**

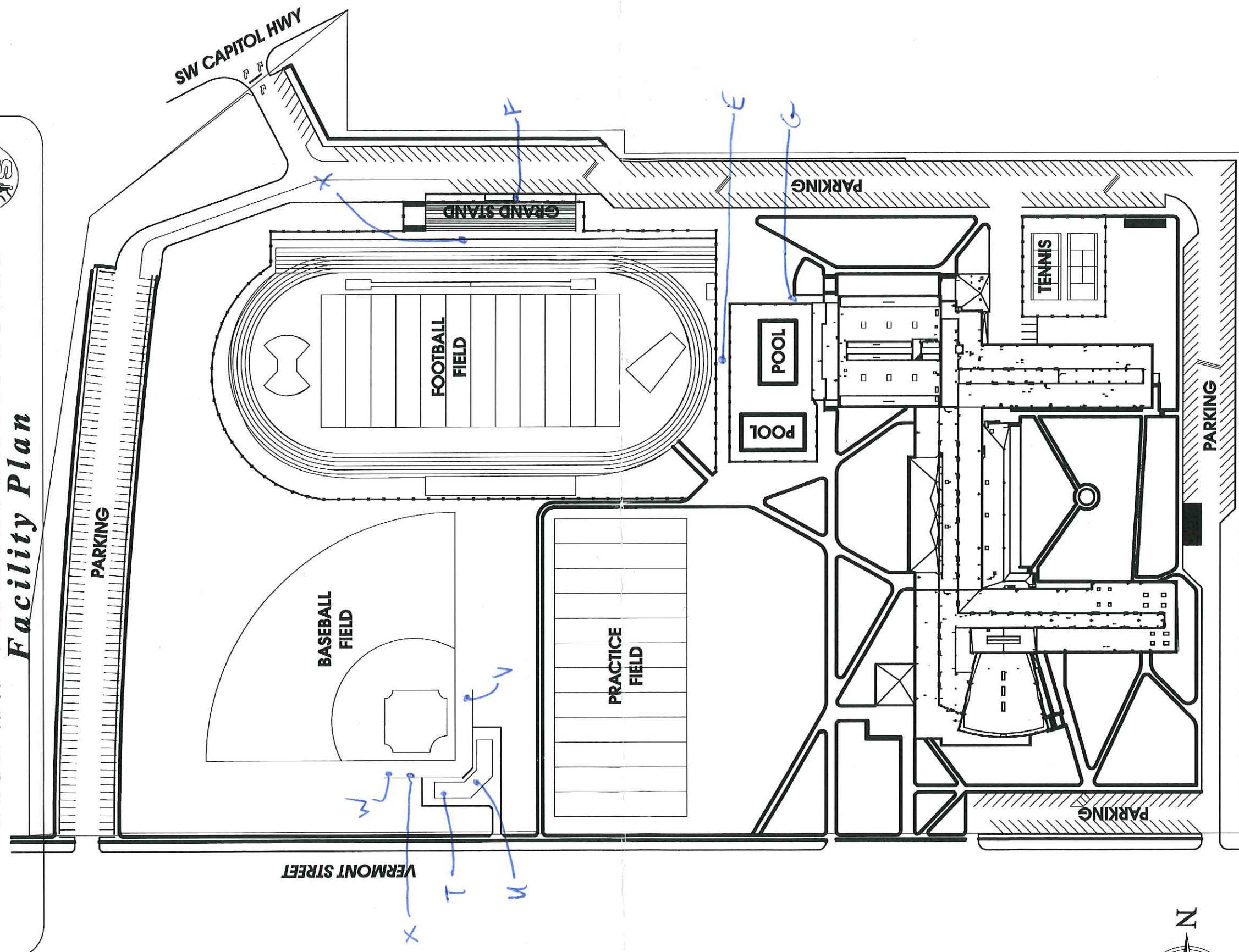

**SITE / ROOF PLAN**











**Wilson High School**  
**1151 SW Vermont Street 97219**  
**Facility Plan**

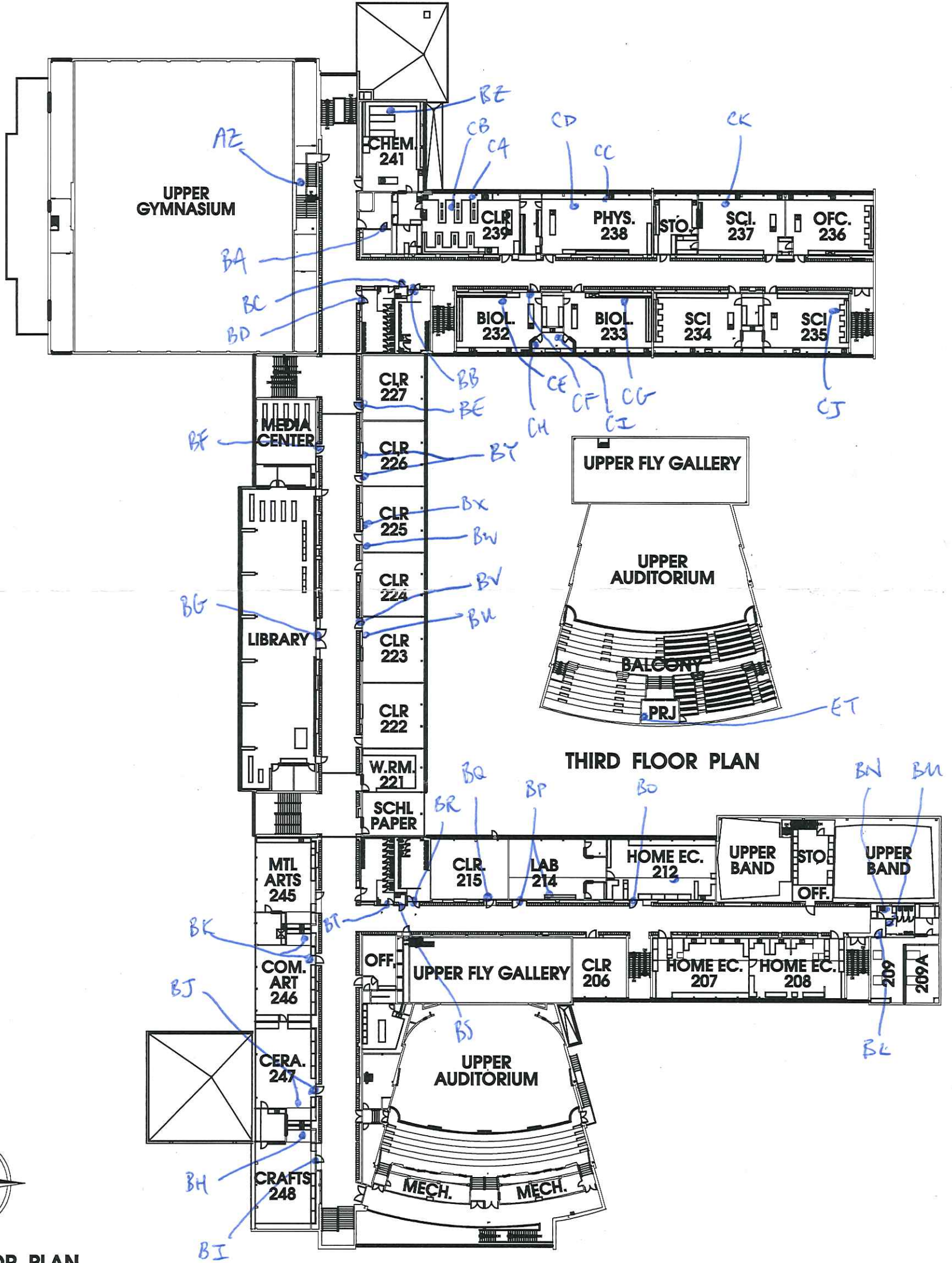

**SECOND FLOOR PLAN**

June 9, 2016

Clark R. Nelson  
PBS Engineering and Environmental Inc.  
4412 S.W. Corbett Ave  
Portland, OR 97239

800 NE Oregon Street, Suite 640  
Portland, OR 97232  
Phone: (971) 673-0440  
Fax: (971) 673-0457  
TTY Nonvoice: (971) 673-0372

RE: LEAD-BASED PAINT ACTIVITIES, INDIVIDUAL CERTIFICATION NO. 1806--Indv--R

This letter is your official notification that you have met the certification requirements under Oregon Administrative Rule (OAR) 333-069 to conduct lead-based paint activities in Oregon, in the following disciplines: Risk Assessor; Inspector

In addition to certification by the Oregon Health Authority, you are required to be licensed by the Construction Contractors Board (CCB) if you plan to conduct lead-based paint activities in Oregon. This license is different than, and in addition to, the standard contractor license issued by CCB. Both individuals and firms must obtain this license. For more information on CCB lead-based paint licensing, visit their web site at [www.oregon.gov/CCB](http://www.oregon.gov/CCB) or call 503-378-4621.

As a certified individual in Oregon, you must meet all the requirements of OAR 333-069, including work practice standards for conducting lead-based paint activities in target housing and child-occupied facilities. As a certified individual, you must perform work under a firm that is certified by the Authority for conducting lead-based paint activities.

You are required to wear the enclosed badge in plain view when conducting lead-based paint activities. Please note that the badge and certificate will expire on 6/30/2017. If you wish to maintain your certification after 6/30/2017, you must submit an application postmarked at least 60 days before expiration and document that your lead-based paint activities training is current.

As a public service the Authority publishes a list of individuals performing lead-based paint activities in Oregon. The list is distributed statewide to consumers interested in lead-based paint activities. Individuals that are certified by the state are eligible to be on this list.

If you have any questions concerning your certification or other aspects of the Lead-Based Paint Program, please contact program staff at 971-673-0440.

Sincerely,

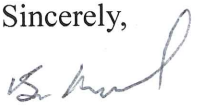
  
Ben Maynard  
Lead-Based Paint Program  
Oregon Health Authority

Enclosures: 1) Badge; 2) Certificate



**Clark R. Nelson**

**Risk Assessor  
Inspector  
Lead-Based Paint  
Activities  
CERTIFICATION  
# 1806--Indv--R  
6/30/2017**

Expires

CERTIFIED

State of Oregon  
Oregon Health Authority

**Clark R. Nelson**

is certified by the Oregon Health Authority to conduct Lead-Based Paint Activities

**Risk Assessor**

Certification Number:	1806--Indv--R
Issuance Date:	6/9/2016
Expiration Date:	6/30/2017

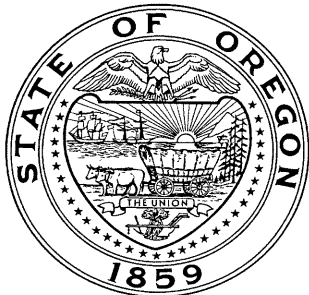

Oregon  
**Health**  
Authority



CLARK RICHARD NELSON  
4412 SW CORBETT AVE  
PORTLAND, OR 97239

**CONSTRUCTION CONTRACTORS BOARD  
LEAD BASED PAINT  
RISK ASSESSOR LICENSE**

EXPIRATION DATE: 6/24/2017

This document certifies that

CLARK RICHARD NELSON  
4412 SW CORBETT AVE  
PORTLAND, OR 97239

is licensed in accordance with Oregon Law as  
a Lead Based Paint Risk Assessor.

**9151806-RA**

**STATE OF OREGON  
CONSTRUCTION CONTRACTORS BOARD  
LEAD BASED PAINT  
RISK ASSESSOR LICENSE**

**LICENSE NUMBER: 9151806-RA**

This document certifies that:

CLARK RICHARD NELSON  
4412 SW CORBETT AVE  
PORTLAND, OR 97239

is licensed in accordance with Oregon Law as a Lead Based Paint Risk Assessor.

**License Details:**

LICENSE NO.: 9151806-RA  
EXPIRATION DATE: 6/24/2017

May 17, 2016

PBS Engineering and Environmental Inc.  
4412 SW Corbett Ave  
Portland, OR 97239

800 NE Oregon Street, Suite 640  
Portland, OR 97232  
Phone: (971) 673-0440  
Fax: (971) 673-0457  
TTY Nonvoice: (971) 673-0372

Attention: Derek May

RE: LEAD-BASED PAINT ACTIVITIES, FIRM CERTIFICATION NO. 1038--LBP FIRM

This letter is your official notification that PBS Engineering and Environmental Inc. has met certification requirements under Oregon Administrative Rules (OAR) 333-069 to conduct lead-based paint activities in Oregon. Please note that the enclosed certificate will expire on 6/30/2017.

In addition to certification by the Oregon Health Authority (Authority), PBS Engineering and Environmental Inc. is required to be licensed by the Construction Contractors Board (CCB) prior to conducting lead-based paint activities in Oregon. This license is different than, and in addition to, the standard contractor license issued by CCB. Both individuals and firms must obtain this license. For more information on CCB lead paint licensing, visit their web site at [www.oregon.gov/CCB](http://www.oregon.gov/CCB) or call 503-378-4621.

As a firm certified to conduct lead-based paint inspection activities in Oregon, PBS Engineering and Environmental Inc. must meet all requirements set forth in OAR 333-069. It must comply with standards for conducting lead-based paint inspection and/or risk assessment activities in target housing and child-occupied facilities and employ only certified individuals to conduct regulated activities.

As a public service, the Authority publishes a list of firms performing lead-based paint activities in Oregon. The list is distributed statewide to consumers interested in lead-based paint services. Only those firms that are certified by the state are eligible to be on this list.

If you have any questions concerning this certification or other aspects of the Lead-Based Paint Program, please contact program staff at (971) 673-0440.

Sincerely,



Ben Maynard  
Lead-Based Paint Program  
Oregon Health Authority

This document can be obtained in an alternate format by calling: (971) 673-0440.

State of Oregon  
Oregon Health Authority

**PBS Engineering and Environmental Inc.**

is certified by the Oregon Health Authority to conduct Lead-Based Paint Activities

Certification Number:	1038--LBP FIRM
Issuance Date:	5/16/2016
Date of Expiration:	6/30/2017



Oregon  
**Health**  
Authority



PBS ENGINEERING & ENVIRONMENTAL INC  
4412 SW CORBETT  
PORTLAND OR 97239

CONSTRUCTION CONTRACTORS BOARD  
LEAD INSPECTION CONTRACTORS LICENSE  
LICENSE No.: LBPI129143  
EXPIRATION DATE: 7/31/2017

This document certifies that

PBS ENGINEERING & ENVIRONMENTAL INC  
4412 SW CORBETT  
PORTLAND OR 97239

is licensed in accordance with Oregon Law as  
a Lead Inspection Contractor.

STATE OF OREGON  
CONSTRUCTION CONTRACTORS BOARD  
LEAD INSPECTION CONTRACTORS LICENSE

LICENSE NUMBER: LBPI129143

This document certifies that:

PBS ENGINEERING & ENVIRONMENTAL INC  
4412 SW CORBETT  
PORTLAND OR 97239

is licensed in accordance with Oregon Law as a Lead Inspection Contractor.

**License Details:**

LBPI LICENSE NO.: LBPI129143  
EXPIRATION DATE: 7/31/2017