



Engineering +
Environmental

February 2, 2017

Courtney Wilton
Portland Public Schools
501 North Dixon
Portland, OR 97227

Via email: cwilton@pps.net

Regarding: Lead Paint Condition Assessment
James John Elementary School
7439 N Charleston Avenue
Portland, Oregon 97203
PBS Project: 6500.721 Phase 0026

Dear Mr. Wilton:

On January 26, 2017, PBS Engineering and Environmental Inc. conducted a visual inspection and assessment of painted and varnished surfaces on the interior and exterior of James John Elementary School located at 7439 North Charleston Avenue in Portland, Oregon.

PBS assessed painted and varnished interior and exterior surfaces as well as concrete, asphalt, soil, playground equipment, and windowsills adjacent or in close proximity to deteriorated painted or varnished surfaces.

Paint and varnish conditions were assessed using US Department of Housing and Urban Development (HUD) guidelines for the Evaluation and Control of Lead Based Paint Hazards in Housing (2012 Addition) Chapter 5: Risk Assessment and Reevaluation.

It is assumed that all paint and varnish at the school contain some concentration of lead. The purpose of this investigation is to identify those finishes in deteriorated condition.

FINDINGS

Overall, the building's painted and varnished surfaces were found to be in intact condition with areas of deteriorated conditions. A table listing the locations and quantity of surfaces in deteriorated condition is attached to this report.

Windows in the school's main building were mostly new metal-frame with some old wood and metal frame windows located in the hallways, restrooms, main exterior doors, and windows facing the courtyard. Paint chips were observed in old painted metal and wood framed window troughs. It should be assumed all old painted metal and wood framed window troughs contain pain chips.

Windows in the older northwest building were old wood and metal frame. Paint chips were observed in representative windows assessed in this building, and it should be assumed that they exist in all of its windows.

Paint chips were also observed in soil on the east side of the school.

4412 SW Corbett Avenue, Portland, OR 97239
503.248.1939 Main
866.727.0140 Fax
888.248.1939 Toll-Free
www.pbsenv.com

Painted playground and parking lot striping and curbing often contain lead and are generally in deteriorated condition due to weatherization and traffic. PBS did not assess this paint, but recommends restriping, as needed, to maintain in intact condition.

RECOMMENDATIONS

PBS recommends that all painted or varnished surfaces in deteriorated condition noted on the attached table be stabilized. Paint chips in windowsills of the older northwest building, and in soil on the east side of the school, should be removed.

Please feel free to contact me at 503 417 7691 or clark@pbsenv.com with any questions or comments.

Sincerely,
PBS Engineering and Environmental Inc.



Clark Nelson, CIH
Senior Project Manager

Attachments: Condition Assessment of Deteriorated Paint/Varnish Table
Field Drawing of Deteriorated Paint and Varnish Locations
Lead-based Paint Risk Assessor Certification (Clark Nelson)
Lead-based Paint Activities Firm Certification (PBS Engineering and Environmental)

CN:DM:bmp

**James John Elementary School
Assessment of Paint/Varnish in Deteriorated Condition**

ID	Interior / Exterior	Location	Structure	Above / Below five feet	K-2nd Grade	Substrate	Square Feet
A	Exterior	Northeast corner of the property	Flag pole	Above and below	Yes	Metal	50
B	Exterior	East side of school, second door from north	Door frame	Above and below	Yes	Wood	10
C	Exterior	Exterior stairwell, south of cafeteria	Downspout	Below	Yes	Metal	5
D	Exterior	West kitchen stairwell	Downspout	Above and below	Yes	Metal	10
E	Exterior	Stairwell north of cafeteria	Downspout	Below	Yes	Metal	5
F	Exterior	Storage shed	Door and frame	Above and below	Yes	Wood	15
G	Exterior	Storage shed	Wall	Above and below	Yes	Wood	20
H	Exterior	Detached northwest building	Stairwells and hand rails	Below	Yes	Wood	500
I	Exterior	Detached northwest building	Window frames	Above	Yes	Wood	200
J	Exterior	Detached northwest building	Walls	Above and below	Yes	Wood	200
K	Exterior	Small playground	Play structure	Above and below	Yes	Metal	25
L	Exterior	Play shed	Basketball hoop posts	Above and below	Yes	Metal	20
M	Exterior	Play shed	Play shed posts and cover	Above and below	Yes	Wood	1000
N	Exterior	Play shed	Downspout	Above and below	Yes	Metal	40
O	Exterior	John Street and Kellog Avenue driveway	Posts	Below	Yes	Metal	40
P	Exterior	Large playground	Play structure	Above and below	Yes	Metal	20
Q	Exterior	Large playground	Basketball hoop posts	Above and below	Yes	Metal	30
R	Interior	Classroom 39	Door and frame	Above and below	Yes	Wood	30
S	Interior	Classroom 39	Cabinets	Below	Yes	Wood	10
T	Interior	Classroom 40	Door, frame, cabinets, and trim	Above and below	Yes	Wood	75
U	Interior	Classroom 40	Wall	Above and below	Yes	Wood	20
V	Interior	Classroom 40	Window trim	Above and below	Yes	Wood	30
W	Interior	Classroom 38	Door and frame	Above and below	Yes	Wood	30

ID	Interior / Exterior	Location	Structure	Above / Below five feet	K-2nd Grade	Substrate	Square Feet
X	Interior	Classroom 38	Cabinets	Above and below	Yes	Wood	100
Y	Interior	Classroom 38	Wall	Above and below	Yes	Wood	50
Z	Interior	Classroom 38	Window frames	Above and below	Yes	Wood	40
AA	Interior	Classroom 38	Window frames	Below	Yes	Metal	20
AB	Interior	Classroom 37	Radiators	Above and below	Yes	Wood	30
AC	Interior	Classroom 37	Door and frame	Below	Yes	Metal	20
AD	Interior	Classroom 37	Radiators	Above and below	Yes	Wood	60
AE	Interior	Classroom 37	Cabinets	Above and below	Yes	Wood	40
AF	Interior	Classroom 36	Window frames	Above and below	Yes	Wood	30
AG	Interior	Classroom 36	Window frames	Above and below	Yes	Wood	50
AH	Interior	Classroom 36	Cabinets	Above and below	Yes	Wood	40
AI	Interior	Classroom 42	Door and frame	Above and below	Yes	Wood	30
AJ	Interior	Classroom 42	Cabinets	Above and below	Yes	Wood	50
AK	Interior	Classroom 42	Wall	Above and below	Yes	Wood	40
AL	Interior	Classroom 42	Door and frame	Above	Yes	Wood	30
AM	Interior	Boys restroom and staff restroom	Wall	Above and below	No	Wood	30
AN	Interior	Boys restroom	Door and frame	Above and below	Yes	Wood	50
AO	Interior	Custodial closet next to classroom 42	Door and frame	Above and below	Yes	Wood	20
AP	Interior	Girls restroom 39A	Door and frame	Above and below	Yes	Wood	15
AQ	Interior	Girls restroom 39A	Wall	Above and below	Yes	Wood	30
AR	Interior	Girls restroom 39A	Window frames	Above and below	Yes	Wood	25
AS	Interior	IT room next to classroom 38	Door and frame	Above and below	No	Wood	15
AT	Interior	Northwest detached building hallway	Wall	Above and below	Yes	Wood	300
AU	Interior	Northwest detached building hallway	Floor	Below	Yes	Wood	750

ID	Interior / Exterior	Location	Structure	Above / Below five feet	K-2nd Grade	Substrate	Square Feet
AW	Interior	Library and library storage	Doors, frames, and shelves	Above and below	Yes	Wood	200
AX	Interior	Library	Wall	Above and below	Yes	Plaster	10
AY	Interior	Cafeteria	Door and frame	Above and below	Yes	Wood and metal	100
AZ	Interior	Classroom 35	Door and frame	Above and below	Yes	Wood	100
BA	Interior	Classroom hallway 35	Window frames	Above	Yes	Metal	20
BB	Interior	Staff lunch room 38	Cabinets	Below	No	Wood	70
BC	Interior	Kitchen storage 39C	Walls and ceilings	Above and below	No	Concrete and plaster	50
BD	Interior	Kitchen storage 39B	Walls and ceilings	Above and below	No	Concrete and plaster	50
BE	Interior	Kitchen 39	Door and frame	Above and below	No	Wood	100
BF	Interior	Kitchen 39	Floor	Below	Yes	Concrete	250
BG	Interior	Kitchen 39	Walls	Above and below	Yes	Plaster	25
BH	Interior	Boiler room	Door and frame	Above and below	No	Wood and metal	200
BI	Interior	Boiler room	Stairwells and hand rails	Below	No	Metal	75
BJ	Interior	Boiler room	Walls, ceilings, and floors	Above and below	No	Concrete	10,000
BK	Interior	Gym office 36B	Floor and cabinets	Above and below	No	Wood	300
BL	Interior	Gym 36	Lockers	Below	Yes	Metal	150
BM	Interior	Gym 36	Walls	Above and below	Yes	Concrete	300
BN	Interior	Gym 36	Door and frame	Above and below	Yes	Wood	50
BO	Interior	Gym storage 36C	Floor and walls	Above and below	No	Concrete	100
BP	Interior	Gym storage 36C	Floor and walls	Above and below	No	Concrete and plaster	300
BQ	Interior	Gym storage 36C	Radiator and pipe cover	Above and below	No	Metal	20
BR	Interior	Custodial and storage closets, 28B	Door and frame	Above and below	No	Wood	75
BS	Interior	Custodial and storage closets, 28B	Floor and walls	Above and below	No	Concrete and plaster	200
BT	Interior	Supply room 28C	Door and frame	Above and below	No	Wood	15

ID	Interior / Exterior	Location	Structure	Above / Below five feet	K-2nd Grade	Substrate	Square Feet
BU	Interior	Supply room 28C	Window frame and radiator	Above and below	No	Metal	25
BV	Interior	Storage room and custodial closet, 25A	Door, frame, and cabinets	Above and below	No	Wood	20
BW	Interior	Storage room and custodial closet, 25A	Floors	Below	No	Concrete	150
BX	Interior	Storage room and custodial closet, 25A	Walls	Above and below	No	Plaster	100
BY	Interior	Office and adjacent restroom	Door, frame, and cabinets	Above and below	No	Wood	30
BZ	Interior	Classroom 22	Wall	Above and below	Yes	Plaster	50
CA	Interior	Classroom 22	Door and frame	Above and below	Yes	Wood	25
CB	Interior	Classroom 21	Door and frame	Above and below	Yes	Wood	15
CC	Interior	Classroom 20	Door and frame	Above and below	Yes	Wood	15
CD	Interior	Classroom 19 and 19A	Door, frame, and cabinets	Above and below	Yes	Wood	75
CE	Interior	Classroom 19	Unit ventilator	Below	Yes	Metal	50
CF	Interior	Bathroom 19C	Radiator	Below	Yes	Metal	20
CG	Interior	Classroom 34	Door, frame, and cabinets	Above and below	Yes	Wood	50
CH	Interior	Girls restroom 20A	Door and frame	Above and below	Yes	Wood	40
CI	Interior	Girls restroom 20A	Window frames	Above	Yes	Metal	40
CJ	Interior	Old boys restroom	Door and frame	Above and below	No	Wood	15
CK	Interior	Old boys restroom	Wall	Below	No	Plaster	10
CL	Interior	Office 23	Door, frames, cabinets, baseboard	Above and below	No	Wood	100
CM	Interior	Office 23	Radiator	Below	No	Metal	20
CN	Interior	Storage next to office 23	Door, frame, and shelves	Above and below	No	Wood	150
CO	Interior	Book storage, 25	Door, frames, and baseboards	Above and below	No	Wood	50
CP	Interior	Book storage, 25	Wall	Above	No	Plaster	10
CQ	Interior	Auditorium 26, east door	Door and frame	Above and below	Yes	Wood	50
CR	Interior	Auditorium 26, stage right	Floor	Below	Yes	Linoleum	20

ID	Interior / Exterior	Location	Structure	Above / Below five feet	K-2nd Grade	Substrate	Square Feet
CS	Interior	Auditorium 26, stage left	Floor	Below	Yes	Linoleum	20
CT	Interior	Auditorium 26, stage left	Door	Above and below	Yes	Wood	5
CU	Interior	Auditorium 26, backstage	Upper walls	Above	Yes	Plaster	20
CV	Interior	Auditorium 26	Stage	Above and below	Yes	Wood	400
CW	Interior	Auditorium 26	Window frames	Above	Yes	Wood	60
CX	Interior	Auditorium 26	Floor	Below	Yes	Linoleum	1000
CY	Interior	Auditorium 26	Chairs	Below	Yes	Wood	1350
CZ	Interior	Auditorium 26	Baseboards	Below	Yes	Wood	100
DA	Interior	Restrooms 30A/B	Door and frame	Above and below	Yes	Wood	30
DB	Interior	girls restroom 30B	Wall	Above	Yes	Plaster	20
DC	Interior	Classroom 31	Door, frame, and baseboard	Above and below	Yes	Wood	50
DD	Interior	Classroom closet 31	Radiator	Below	No	Metal	15
DE	Interior	Classroom 31	Unit ventilator	Below	Yes	Metal	15
DF	Interior	Classroom 30	Door and frame	Above and below	Yes	Wood	15
DG	Interior	Classroom 29	Door and frame	Above and below	Yes	Wood	15
DH	Interior	Classroom 29	Unit ventilator	Below	Yes	Metal	30
DI	Interior	Classroom 28	Door, frame, and cabinets	Above and below	Yes	Wood	100
DJ	Interior	Main offices 27, 27 A, 27 B	Door, frame, and cabinets	Above and below	No	Wood	200
DK	Interior	Main offices 26B	Radiator	Below	No	Metal	15
DL	Interior	Main offices 27	Wall	Below	No	Plaster	10
DM	Interior	Cafeteria Hallway	Ladder	Above and below	Yes	Metal	20
DN	Interior	Cafeteria Hallway	Window frame	Above	Yes	Metal	20
DO	Interior	Main entrance	Door, frame, and window frame	Above and below	Yes	Wood	40
DP	Interior	Northeast entrance	Door, frame, and window frame	Above and below	Yes	Wood	40

ID	Interior / Exterior	Location	Structure	Above / Below five feet	K-2nd Grade	Substrate	Square Feet
DQ	Interior	Northwest entrance	Door and frame	Above and below	Yes	Wood	20
DR	Interior	Northwest entrance	Floor and curbing	Below	Yes	Linoleum	150
DS	Interior	Throughout the main floor	Lockers	Below	Yes	Metal	1000
DT	Interior	Throughout the main floor	Baseboard and trim	Above and below	Yes	Wood	500
DU	Interior	Second floor, south stairwell	Handrails and trim	Below	Yes	Wood	100
DV	Interior	Second floor, south stairwell	Floor	Below	Yes	Linoleum	300
DW	Interior	Second floor, north stairwell	Handrails and trim	Below	Yes	Wood	100
DX	Interior	Second floor, north stairwell	Floor	Below	Yes	Linoleum	300
DY	Interior	Second floor, northwest stairwell	Handrails and trim	Below	Yes	Wood	100
DZ	Interior	Second floor, northwest stairwell	Floor	Below	Yes	Linoleum	300
EA	Interior	Classroom 1	Door, frame, and trim	Above and below	No	Wood	60
EB	Interior	Classroom 1	Wall	Above and below	No	Plaster	30
EC	Interior	Second floor, northwest hallway	Window frame	Above	Yes	Wood	15
ED	Interior	Second floor, northwest stairwell	Window frame	Above	Yes	Wood	30
EE	Interior	Classroom 2	Door, frame, and trim	Above and below	No	Wood	60
EF	Interior	Classroom entryway 2	Wall and ceiling	Above and below	No	Plaster	10
EG	Interior	Second floor, girls restroom	Door and frame	Above and below	Yes	Wood	20
EH	Interior	Second floor, girls restroom	Window frame and alcove	Above	Yes	Plaster	20
EI	Interior	Classroom 4	Door, frame, and trim	Above and below	Yes	Wood	30
EJ	Interior	Restroom 3B	Door and frame	Above and below	Yes	Wood	15
EK	Interior	Classroom 3	Door, frame, and trim	Above and below	No	Wood	60
EL	Interior	Classroom 3	Wall	Above	No	Plaster	20
EM	Interior	Classroom 5	Door, frame, and trim	Above and below	No	Wood	60
EN	Interior	Classroom 5	Wall	Above and below	No	Plaster	20

ID	Interior / Exterior	Location	Structure	Above / Below five feet	K-2nd Grade	Substrate	Square Feet
EO	Interior	Office 6	Door, frame, and cabinets	Above and below	No	Wood	60
EP	Interior	Office 6	Window alcove	Above	No	Plaster	5
EQ	Interior	Classroom 7	Door, frame, and trim	Above and below	No	Wood	60
ER	Interior	Classroom 7	Wall	Below	No	Plaster	10
ES	Interior	Projection room	Door, frame, and handrail	Above and below	No	Wood	25
ET	Interior	Projection room	Stairs	Below	No	Metal	25
EU	Interior	Projection room	Floor	Below	No	Linoleum	50
EV	Interior	Projection room	Walls	Above and below	No	Plaster	10
EW	Interior	Balcony	Door and frame	Above and below	Yes	Wood	25
EX	Interior	Balcony	Seats	Below	Yes	Wood	535
EY	Interior	Balcony	Floor	Below	Yes	Linoleum	750
EZ	Interior	Balcony	Handrail	Below	Yes	Metal	25
FA	Interior	North storage closet	Ceiling	Above	No	Plaster	20
FB	Interior	Classroom 15	Window frame	Above and below	Yes	Metal	20
FC	Interior	Classroom 15, custodial closet and north storage closet	Door, frame, trim, and cabinets	Above and below	Yes	Wood	200
FD	Interior	Classroom 15	Unit ventilator	Below	Yes	Metal	10
FE	Interior	Classroom 15, custodial closet and north storage closet	Floor	Below	Yes	Wood	300
FF	Interior	Classroom 8, closet 8B	Door, frame, trim, and cabinets	Above and below	Yes	Wood	200
FG	Interior	Custodial closet	Floor	Below	Yes	Linoleum	300
FH	Interior	Classroom 8	Window frame	Above and below	Yes	Metal	20
FI	Interior	Classroom 9	Door, frame, and trim	Above and below	No	Wood	60
FJ	Interior	Classroom 9	Floor	Below	No	Linoleum	500
FK	Interior	Teacher's room 10	Door, frame, and baseboard	Above and below	No	Wood	100
FL	Interior	Teacher's room 10	Floor and curbing	Below	No	Linoleum	350

ID	Interior / Exterior	Location	Structure	Above / Below five feet	K-2nd Grade	Substrate	Square Feet
FM	Interior	Teacher's room 10	Wall	Below	No	Plaster	5
FN	Interior	Classroom 11	Door, frame, and trim	Above and below	No	Wood	60
FO	Interior	Classroom 11	Walls	Above and below	No	Plaster	20
FP	Interior	Classroom 11	Unit ventilator	Below	No	Metal	10
FQ	Interior	Classroom 12	Door, frame, trim, and cabinets	Above and below	No	Wood	100
FR	Interior	Classroom 12	Wall	Below	No	Plaster	15
FS	Interior	Classroom 13	Door, frame, and trim	Above and below	No	Wood	60
FT	Interior	Classroom 13	Wall	Above and below	No	Plaster	15
FU	Interior	Southwest second floor hallway	Window frame	Above	Yes	Wood	15
FV	Interior	Classroom 14	Door, frame, and trim	Above and below	No	Wood	60
FW	Interior	Classroom 14	Wall	Below	No	Plaster	5
FX	Interior	boys and girls restrooms 13A and 13B	Door and frame	Above and below	Yes	Wood	40
FY	Interior	boys restroom 13A	Window frames	Above	Yes	Metal	20
FZ	Interior	boys and girls restrooms 13A	Walls	Below	Yes	Plaster	5
GA	Interior	Second floor hallways	Lockers	Below	Yes	Metal	1000
GB	Interior	Second floor hallways	Trim	Above and below	Yes	Wood	500
GC	Interior	North second floor hallway	Ladder	Above and below	Yes	Metal	20
GD	Interior	South second floor hallway	Ladder	Above and below	Yes	Metal	20

James John Elementary School 7439 N Charleston 97203 Facility Plan

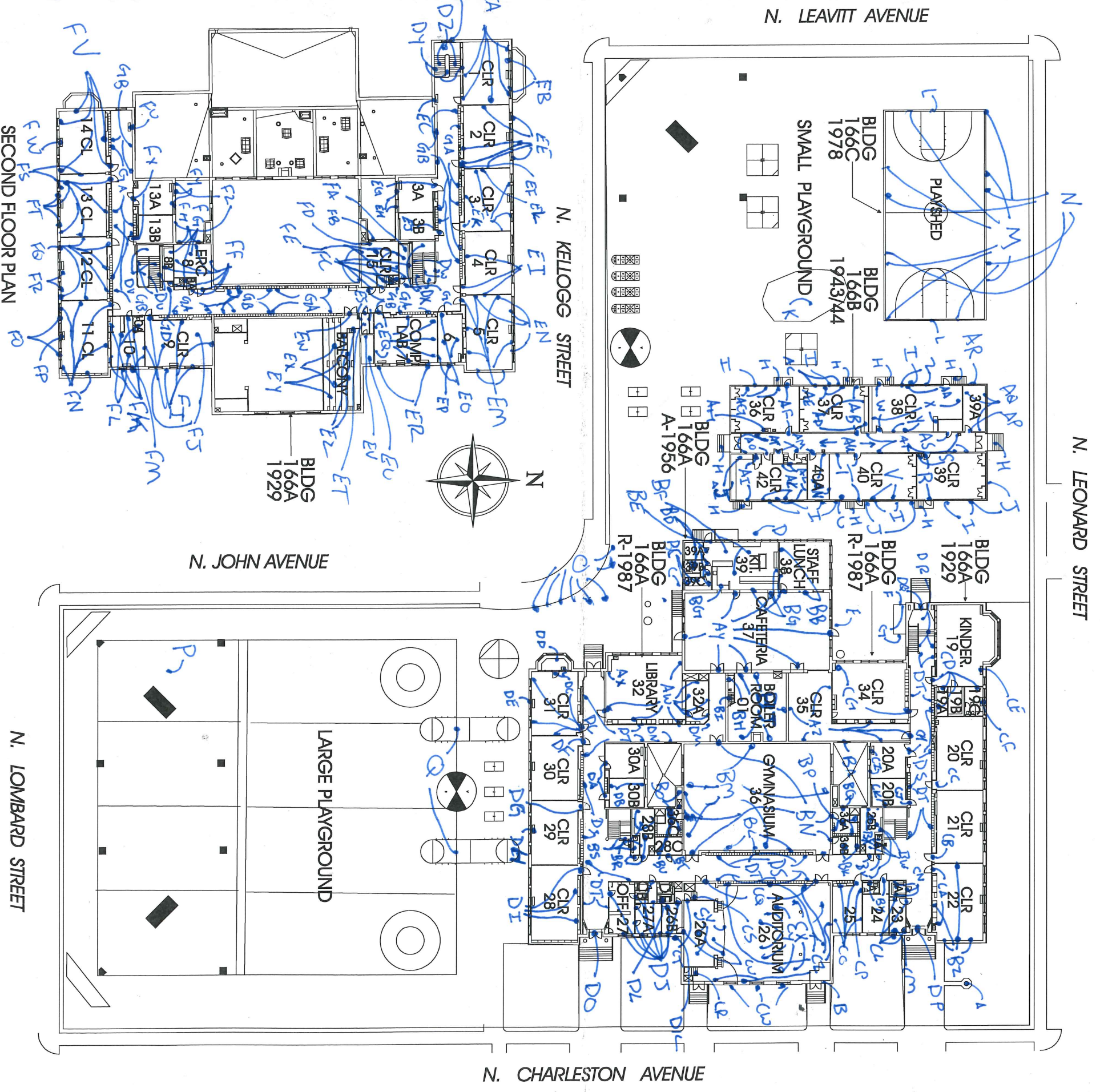

TOTAL SF 63,697
ACRES 3.31
1/4 SECT. 2122

SECOND FLOOR PLAN

June 9, 2016

Clark R. Nelson
PBS Engineering and Environmental Inc.
4412 S.W. Corbett Ave
Portland, OR 97239

800 NE Oregon Street, Suite 640
Portland, OR 97232
Phone: (971) 673-0440
Fax: (971) 673-0457
TTY Nonvoice: (971) 673-0372

RE: LEAD-BASED PAINT ACTIVITIES, INDIVIDUAL CERTIFICATION NO. 1806--Indv--R

This letter is your official notification that you have met the certification requirements under Oregon Administrative Rule (OAR) 333-069 to conduct lead-based paint activities in Oregon, in the following disciplines: Risk Assessor; Inspector

In addition to certification by the Oregon Health Authority, you are required to be licensed by the Construction Contractors Board (CCB) if you plan to conduct lead-based paint activities in Oregon. This license is different than, and in addition to, the standard contractor license issued by CCB. Both individuals and firms must obtain this license. For more information on CCB lead-based paint licensing, visit their web site at www.oregon.gov/CCB or call 503-378-4621.

As a certified individual in Oregon, you must meet all the requirements of OAR 333-069, including work practice standards for conducting lead-based paint activities in target housing and child-occupied facilities. As a certified individual, you must perform work under a firm that is certified by the Authority for conducting lead-based paint activities.

You are required to wear the enclosed badge in plain view when conducting lead-based paint activities. Please note that the badge and certificate will expire on 6/30/2017. If you wish to maintain your certification after 6/30/2017, you must submit an application postmarked at least 60 days before expiration and document that your lead-based paint activities training is current.

As a public service the Authority publishes a list of individuals performing lead-based paint activities in Oregon. The list is distributed statewide to consumers interested in lead-based paint activities. Individuals that are certified by the state are eligible to be on this list.

If you have any questions concerning your certification or other aspects of the Lead-Based Paint Program, please contact program staff at 971-673-0440.

Sincerely,

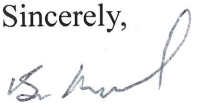
Ben Maynard
Lead-Based Paint Program
Oregon Health Authority

Enclosures: 1) Badge; 2) Certificate



Clark R. Nelson

**Risk Assessor
Inspector
Lead-Based Paint
Activities
CERTIFICATION
1806--Indv--R
6/30/2017**

Expires

CERTIFIED

State of Oregon
Oregon Health Authority

Clark R. Nelson

is certified by the Oregon Health Authority to conduct Lead-Based Paint Activities

Risk Assessor

Certification Number:	1806--Indv--R
Issuance Date:	6/9/2016
Expiration Date:	6/30/2017

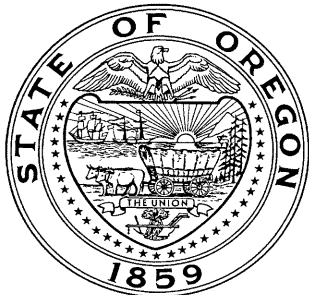

Oregon
Health
Authority

CLARK RICHARD NELSON
4412 SW CORBETT AVE
PORTLAND, OR 97239

**CONSTRUCTION CONTRACTORS BOARD
LEAD BASED PAINT
RISK ASSESSOR LICENSE**

EXPIRATION DATE: 6/24/2017

This document certifies that

CLARK RICHARD NELSON
4412 SW CORBETT AVE
PORTLAND, OR 97239

is licensed in accordance with Oregon Law as
a Lead Based Paint Risk Assessor.

9151806-RA

**STATE OF OREGON
CONSTRUCTION CONTRACTORS BOARD
LEAD BASED PAINT
RISK ASSESSOR LICENSE**

LICENSE NUMBER: 9151806-RA

This document certifies that:

CLARK RICHARD NELSON
4412 SW CORBETT AVE
PORTLAND, OR 97239

is licensed in accordance with Oregon Law as a Lead Based Paint Risk Assessor.

License Details:

LICENSE NO.: 9151806-RA
EXPIRATION DATE: 6/24/2017

May 17, 2016

PBS Engineering and Environmental Inc.
4412 SW Corbett Ave
Portland, OR 97239

800 NE Oregon Street, Suite 640
Portland, OR 97232
Phone: (971) 673-0440
Fax: (971) 673-0457
TTY Nonvoice: (971) 673-0372

Attention: Derek May

RE: LEAD-BASED PAINT ACTIVITIES, FIRM CERTIFICATION NO. 1038--LBP FIRM

This letter is your official notification that PBS Engineering and Environmental Inc. has met certification requirements under Oregon Administrative Rules (OAR) 333-069 to conduct lead-based paint activities in Oregon. Please note that the enclosed certificate will expire on 6/30/2017.

In addition to certification by the Oregon Health Authority (Authority), PBS Engineering and Environmental Inc. is required to be licensed by the Construction Contractors Board (CCB) prior to conducting lead-based paint activities in Oregon. This license is different than, and in addition to, the standard contractor license issued by CCB. Both individuals and firms must obtain this license. For more information on CCB lead paint licensing, visit their web site at www.oregon.gov/CCB or call 503-378-4621.

As a firm certified to conduct lead-based paint inspection activities in Oregon, PBS Engineering and Environmental Inc. must meet all requirements set forth in OAR 333-069. It must comply with standards for conducting lead-based paint inspection and/or risk assessment activities in target housing and child-occupied facilities and employ only certified individuals to conduct regulated activities.

As a public service, the Authority publishes a list of firms performing lead-based paint activities in Oregon. The list is distributed statewide to consumers interested in lead-based paint services. Only those firms that are certified by the state are eligible to be on this list.

If you have any questions concerning this certification or other aspects of the Lead-Based Paint Program, please contact program staff at (971) 673-0440.

Sincerely,



Ben Maynard
Lead-Based Paint Program
Oregon Health Authority

This document can be obtained in an alternate format by calling: (971) 673-0440.

State of Oregon
Oregon Health Authority

PBS Engineering and Environmental Inc.

is certified by the Oregon Health Authority to conduct Lead-Based Paint Activities

Certification Number:	1038--LBP FIRM
Issuance Date:	5/16/2016
Date of Expiration:	6/30/2017



Oregon
Health
Authority

PBS ENGINEERING & ENVIRONMENTAL INC
4412 SW CORBETT
PORTLAND OR 97239

CONSTRUCTION CONTRACTORS BOARD
LEAD INSPECTION CONTRACTORS LICENSE
LICENSE No.: LBPI129143
EXPIRATION DATE: 7/31/2017

This document certifies that

PBS ENGINEERING & ENVIRONMENTAL INC
4412 SW CORBETT
PORTLAND OR 97239

is licensed in accordance with Oregon Law as
a Lead Inspection Contractor.

STATE OF OREGON
CONSTRUCTION CONTRACTORS BOARD
LEAD INSPECTION CONTRACTORS LICENSE

LICENSE NUMBER: LBPI129143

This document certifies that:

PBS ENGINEERING & ENVIRONMENTAL INC
4412 SW CORBETT
PORTLAND OR 97239

is licensed in accordance with Oregon Law as a Lead Inspection Contractor.

License Details:

LBPI LICENSE NO.: LBPI129143
EXPIRATION DATE: 7/31/2017