



Engineering +  
Environmental

March 13, 2017

Courtney Wilton  
Portland Public Schools  
501 North Dixon  
Portland, OR 97227

Via email: cwilton@pps.net

Regarding: Lead Paint Condition Assessment  
Beaumont Middle School  
4043 NE Fremont Street  
Portland, Oregon 97212  
PBS Project: 6500.721 Phase 0059

Dear Mr. Wilton:

On February 27, 2017, PBS Engineering and Environmental Inc. (PBS) conducted a visual inspection and assessment of painted and varnished surfaces on the interior and exterior of Beaumont Middle School located at 4043 NE Fremont Street in Portland, Oregon.

PBS assessed painted and varnished interior and exterior hard surfaces as well as concrete, asphalt, soil, garden spaces, playground equipment, and windowsills adjacent or in close proximity to deteriorated painted or varnished surfaces.

Paint and varnish conditions were assessed using US Department of Housing and Urban Development (HUD) guidelines for the Evaluation and Control of Lead Based Paint Hazards in Housing (2012 Addition) Chapter 5: Risk Assessment and Reevaluation.

It is assumed that all paint and varnish at the school contain some concentration of lead. The purpose of this investigation is to identify those finishes in deteriorated condition.

## **FINDINGS**

Overall, the building's painted and varnished surfaces were found to be in intact condition with areas of fair and deteriorated conditions. A table listing the locations and quantity of surfaces in deteriorated condition is attached to this report.

No paint chips were observed in the school's garden; however, paint chips were observed beneath the window in classroom 12A and on concrete in the gym's storage room 25A.

The school has metal sliding windows in a majority of the main building and the gym building; wood varnished windows in the basement and stairwells of the main building; and wood pull-in windows in the arts building. Abrasion was observed on wood varnished windows in the basement and stairwells and on wood pull-in windows in the arts building. Window troughs for these windows were observed to be dirty.

Painted playground and parking lot striping and curbing often contain lead and are generally in deteriorated condition due to weatherization and traffic. PBS did not assess this paint, but recommends restriping, as needed, to maintain in intact condition.

4412 SW Corbett Avenue, Portland, OR 97239  
503.248.1939 Main  
866.727.0140 Fax  
888.248.1939 Toll-Free  
www.pbsenv.com

## RECOMMENDATIONS

PBS recommends that all painted or varnished surfaces in deteriorated condition noted on the attached table be stabilized. All paint chips noted in this report should be removed. Dirty window troughs should be cleaned.

Please feel free to contact me at 503.417.7691 or [clark@pbsenv.com](mailto:clark@pbsenv.com) with any questions or comments.

Sincerely,  
PBS Engineering and Environmental Inc.



Clark Nelson, CIH  
Senior Project Manager

Attachments: Condition Assessment of Deteriorated Paint/Varnish Table  
Field Drawing of Deteriorated Paint and Varnish Locations  
Lead-based Paint Risk Assessor Certification (Clark Nelson)  
Lead-based Paint Activities Firm Certification (PBS Engineering and Environmental)

CN:DM:bmp

**Beaumont Middle School**  
**Assessment of Paint/Varnish in Deteriorated Condition**

ID	Interior / Exterior	Location	Structure	Above / Below five feet	K-2nd Grade	Substrate	Square Feet
A	Interior	Classroom 227	Doorframe	Above and below	No	Wood	15
B	Interior	Classroom 227	Trim around built in cabinets/shelves	Above and below	No	Wood	40
C	Interior	Classroom 227	Baseboards	Below	No	Wood	100
D	Interior	Classroom 222	Doorframe	Above and below	No	Wood	15
E	Interior	Classroom 222	Trim around built in cabinets/shelves	Above and below	No	Wood	40
F	Interior	Classroom 222	Baseboards on east and south walls	Below	No	Wood	50
G	Interior	Classroom 225	Doorframe	Above and below	No	Wood	15
H	Interior	Classroom 225	Trim around built in cabinets/shelves	Above and below	No	Wood	40
I	Interior	Classroom 225	Radiator housing	Below	No	Metal	40
J	Interior	Classroom 220	Doorframe	Above and below	No	Wood	15
K	Interior	Classroom 220	Radiator housing	Below	No	Metal	40
L	Interior	Classroom 220	Built-in cabinets and shelves	Above and below	No	Wood	70
M	Interior	Boys room across from classroom 220	Door	Above and below	No	Wood	45
N	Interior	Boys room across from classroom 220	Window assemblies	Above	No	Wood	45
O	Interior	Classroom 218	Doorframe	Above and below	No	Wood	15
P	Interior	Classroom 218	Built-in cabinets and shelves	Above and below	No	Wood	70
Q	Interior	Classroom 218	Baseboards	Below	No	Wood	100
R	Interior	Classroom 218	Radiator housing	Below	No	Metal	40
S	Interior	Classroom 216	Built-in cabinets and shelves	Above and below	No	Wood	70
T	Interior	Classroom 216	Radiator housing	Below	No	Metal	40
U	Interior	Custodial 221	Doorframe	Above and below	No	Wood	15
V	Interior	Classroom 214		Below	No	Plaster	6

ID	Interior / Exterior	Location	Structure	Above / Below five feet	K-2nd Grade	Substrate	Square Feet
W	Interior	Classroom 214	Baseboards	Below	No	Wood	100
X	Interior	Classroom 214	Built-in cabinets and shelves	Above and below	No	Wood	70
Y	Interior	Classroom 214	Radiator housing	Below	No	Metal	40
Z	Interior	Classroom 214	Doorframe	Above and below	No	Wood	15
AA	Interior	AV storage 219	Window assemblies	Above	No	Wood	20
AB	Interior	AV storage 219	Doorframe	Above and below	No	Wood	15
AC	Interior	Girls room next to classroom 215	Door	Above and below	No	Wood	45
AD	Interior	Girls room next to classroom 215	Window assemblies	Above	No	Wood	20
AE	Interior	Classroom 215	Baseboards	Below	No	Wood	100
AF	Interior	Classroom 215	Radiator housing	Below	No	Metal	40
AG	Interior	Classroom 215	Door and frame	Above and below	No	Wood	60
AH	Interior	Classroom 212	Doorframe	Above and below	No	Wood	15
AI	Interior	Classroom 212	Built-in cabinets and shelves	Above and below	No	Wood	70
AJ	Interior	Classroom 212	Baseboards	Below	No	Wood	100
AK	Interior	Classroom 212	Radiator housing	Below	No	Metal	40
AL	Interior	North stairwell on east side of building	Doorframe	Above and below	No	Wood	15
AM	Interior	North stairwell on east side of building	Handrails	Below	No	Wood	100
AN	Interior	North stairwell on east side of building	Window assemblies	Above	No	Wood	50
AO	Interior	South stairwell on east side of building	Doorframe	Above and below	No	Wood	15
AP	Interior	South stairwell on east side of building	Handrails	Below	No	Wood	100
AQ	Interior	South stairwell on east side of building	Window assemblies	Above	No	Wood	50
AR	Interior	Classroom 213	Doorframe	Above and below	No	Wood	15
AS	Interior	Classroom 213	Radiator housing	Below	No	Metal	40

ID	Interior / Exterior	Location	Structure	Above / Below five feet	K-2nd Grade	Substrate	Square Feet
AT	Interior	Classroom 208	Door and frame	Above and below	No	Wood	60
AU	Interior	Classroom 208	Wall in southeast corner	Above	No	Plaster	20
AV	Interior	Classroom 208	Radiator housing	Below	No	Metal	40
AW	Interior	Classroom 208	Built-in cabinets and shelves	Above and below	No	Wood	40
AX	Interior	Girls room across from classroom 208	Door and frame	Above and below	No	Wood	60
AY	Interior	Teachers restroom	Door and frame	Above and below	No	Wood	60
AZ	Interior	Classroom 206	Doorframe	Above and below	No	Wood	15
BA	Interior	Classroom 206	Baseboards	Below	No	Wood	100
BB	Interior	Classroom 206	Built-in cabinets and shelves	Above and below	No	Wood	40
BC	Interior	Classroom 206	Radiator housing	Below	No	Metal	40
BD	Interior	Classroom 204	Baseboards	Below	No	Wood	100
BE	Interior	Classroom 204	Radiator housing	Below	No	Metal	40
BF	Interior	Classroom 204	Northeast corner wall	Above	No	Plaster	20
BG	Interior	South stairwell	Doorframe	Above and below	No	Wood	15
BH	Interior	South stairwell	Handrails	Below	No	Wood	100
BI	Interior	South stairwell	Window assemblies	Above	No	Wood	50
BJ	Interior	Custodial 205	floor	Below	No	Concrete	35
BK	Interior	Custodial 205	Doorframe	Above and below	No	Wood	15
BL	Interior	Boys room next to classroom 201	Door and frame	Above and below	No	Wood	60
BM	Interior	Boys room next to classroom 201	Window assemblies	Above	No	Wood	20
BN	Interior	Classroom 201	Doorframe	Above and below	No	Wood	15
BO	Interior	Classroom 201	Baseboards	Below	No	Wood	100
BP	Interior	Classroom 201	Radiator housing	Below	No	Metal	40

ID	Interior / Exterior	Location	Structure	Above / Below five feet	K-2nd Grade	Substrate	Square Feet
BQ	Interior	Classroom 201	Built-in cabinets and shelves	Above and below	No	Wood	40
BR	Interior	Classroom 200	Doorframe	Above and below	No	Wood	15
BS	Interior	Classroom 200	Baseboards	Below	No	Wood	100
BT	Interior	Classroom 202	Doorframe	Above and below	No	Wood	15
BU	Interior	Classroom 202	Baseboards	Below	No	Wood	100
BV	Interior	Classroom 202	Built-in cabinets and shelves	Above and below	No	Wood	40
BW	Interior	Southwest corner of second floor	Window assemblies	Above and below	No	Wood	60
BX	Interior	North stairwell	Handrails	Below	No	Wood	100
BY	Interior	North stairwell	Window assemblies	Above	No	Wood	50
BZ	Interior	Northwest stairwell	Handrails	Below	No	Wood	100
CA	Interior	Northwest stairwell	Window assemblies	Above	No	Wood	40
CB	Interior	Northwest building entrance	Double doors and frames	Above and below	No	Wood	120
CC	Interior	Room 28A	Door and frame to exterior	Above and below	No	Metal	60
CD	Interior	Cafeteria 27B	Double door and frame to exterior	Above and below	No	Metal	30
CE	Interior	Kitchen	Door and frame to exterior	Above and below	No	Metal	60
CF	Interior	Room 30	Doorframe	Above and below	No	Metal	15
CG	Interior	Room 30	Window sill	Below	No	Wood	6
CH	Interior	Classroom 20A	Doorframe	Above and below	No	Metal	15
CI	Interior	Classroom 20A	Window sill	Below	No	Wood	6
CJ	Interior	Southeast building entrance to gym café	Double Doorframes	Above and below	No	Metal	30
CK	Interior	Gym 26A	South wall	Above and below	No	Concrete	150
CL	Interior	Gym 26A	North wall	Above and below	No	Concrete	150
CM	Interior	Gym 26A	Northwest exterior doors and frames	Above and below	No	Metal	120

ID	Interior / Exterior	Location	Structure	Above / Below five feet	K-2nd Grade	Substrate	Square Feet
CN	Interior	Gym 26A	Northeast exterior doors and frames	Above and below	No	Metal	120
CO	Interior	Gym storage 25A	Walls	Above and below	No	Concrete	800
CP	Interior	Gym storage 25A	Paint chips on ground	Below	No	Concrete	40
CQ	Interior	Gym storage 25A	Double doors and frames	Above and below	No	Metal	120
CR	Interior	Top of south stairs to stage	Doorframe	Above and below	No	Wood	15
CS	Interior	Gym storage 24A	East wall	Above and below	No	Concrete	20
CT	Interior	Gym storage 24A	Double doors and frames	Above and below	No	Metal	120
CU	Interior	Gym 110	East wall	Below	No	Concrete	20
CV	Interior	Girls locker room 113	Door and frame	Above and below	No	Wood	60
CW	Interior	Girls locker room 113	Door and frame to office	Above and below	No	Wood	60
CX	Interior	Girls locker room 113	Floor	Below	No	Concrete	600
CY	Interior	Gym 111	Double doors to exterior	Above and below	No	Wood	90
CZ	Interior	Gym 111	West wall	Below	No	Concrete	10
DA	Interior	Gym 111	Double doors and frames to exterior	Above and below	No	Wood	120
DB	Interior	Boys locker room 109A	Door and frame	Above and below	No	Wood	60
DC	Interior	Boys locker room 109A	Floor	Below	No	Concrete	600
DD	Interior	Boys locker room 109A	Door to exterior	Above and below	No	Metal	45
DE	Interior	Gym 110/111	Baseboards	Below	No	Wood	300
DF	Interior	Room 119	Door and frame	Above and below	No	Wood	60
DG	Interior	Room 119	North wall	Above and below	No	p	30
DH	Interior	Room 119	Exterior door	Above and below	No	Wood	45
DI	Interior	Room 140	Door and frame	Above and below	No	Wood	45
DJ	Interior	Room 140 office	north wall	Below	No	p	20

ID	Interior / Exterior	Location	Structure	Above / Below five feet	K-2nd Grade	Substrate	Square Feet
DK	Interior	Room 140	Radiator housing	Below	No	Metal	24
DL	Interior	Room 140	Built-in cabinets under sink	Below	No	Wood	15
DM	Interior	Room 140	Built-in cabinets on south wall	Below	No	Wood	30
DN	Interior	Classroom 138	Door and frame	Above and below	No	Wood	60
DO	Interior	Classroom 138	Baseboards	Below	No	Wood	100
DP	Interior	Classroom 138	Radiator housing	Below	No	Metal	40
DQ	Interior	Classroom 138	Trim around built in cabinets/shelves	Below	No	Wood	20
DR	Interior	Sci 136	Built-in cabinets	Above and below	No	Wood	80
DS	Interior	Sci 136	Built-in cabinets under sink	Below	No	Wood	30
DT	Interior	Sci 136	Radiator housing	Below	No	Metal	40
DU	Interior	Sci 136	Baseboards	Below	No	Wood	100
DV	Interior	Sci 136	Doorframe	Above and below	No	Wood	15
DW	Interior	Sci 134	Doorframe	Above and below	No	Wood	15
DX	Interior	Sci 134	Built-in cabinets	Above and below	No	Wood	50
DY	Interior	Sci 134	Baseboards	Below	No	Wood	100
DZ	Interior	Sci 134	Built-in cabinets under sink	Below	No	Wood	50
EA	Interior	Sci 134	Radiator housing	Below	No	Metal	40
EB	Interior	Counselor's office 132	Door and frame	Above and below	No	Wood	60
EC	Interior	Counselor's office 108	Baseboards	Below	No	Wood	50
ED	Interior	Classroom 106	Door and frame	Above and below	No	Wood	60
EE	Interior	Classroom 106	Built-in cabinets under sink	Below	No	Wood	15
EF	Interior	Classroom 106	Radiator housing	Below	No	Metal	40
EG	Interior	Classroom 106	Baseboards	Below	No	Wood	100



ID	Interior / Exterior	Location	Structure	Above / Below five feet	K-2nd Grade	Substrate	Square Feet
EH	Interior	Classroom 104	Door and frame	Above and below	No	Wood	60
EI	Interior	Classroom 104	Baseboards	Below	No	Wood	150
EJ	Interior	Classroom 104	West wall by door	Above and below	No	Plaster	20
EK	Interior	Classroom 104	Built-in cabinets under sinks	Below	No	Wood	120
EL	Interior	Custodial 105A	Door and frame	Above and below	No	Wood	60
EM	Interior	Boys restroom 103	Door	Above and below	No	Wood	45
EN	Interior	Classroom 102	Door and frame	Above and below	No	Wood	60
EO	Interior	Classroom 102	Baseboards	Below	No	Wood	100
EP	Interior	Classroom 102	Radiator housing	Below	No	Metal	40
EQ	Interior	Classroom 100	Door and frame	Above and below	No	Wood	60
ER	Interior	Classroom 100	Baseboards	Below	No	Wood	100
ES	Interior	Classroom 100	Radiator housing	Below	No	Metal	40
ET	Interior	Fac. 101	Door and frame	Above and below	No	Wood	60
EU	Interior	Fac. 101	Baseboards	Below	No	Wood	100
EV	Interior	Southwest building entrance	Double doors and frames	Above and below	No	Wood	120
EW	Interior	North building entrance	Double doors	Above and below	No	Wood	90
EX	Interior	Stairway to basement	Handrails	Below	No	Metal	50
EY	Interior	Classroom 14A	Doorframe	Above and below	No	Wood	15
EZ	Interior	Room 14B	Doorframe	Above and below	No	Wood	15
FA	Interior	Room 13A	North wall	Below	No	Plaster	30
FB	Interior	Classroom 12A	Doorframe	Above and below	No	Wood	15
FC	Interior	Classroom 12A	North wall	Below	No	Plaster	40
FD	Interior	Classroom 12A	Paint chips on carpet under window	Below	No	N/A	10

ID	Interior / Exterior	Location	Structure	Above / Below five feet	K-2nd Grade	Substrate	Square Feet
FE	Interior	Classroom 11	Doorframe	Above and below	No	Wood	15
FF	Interior	Classroom 11	Wall near door	Below	No	Plaster	10
FG	Interior	South arts entrance	Door and frame	Above and below	No	Metal	60
FH	Interior	Room 8	Exterior door and frame	Above and below	No	Wood	60
FI	Interior	Room 8	Door and frame	Above and below	No	Metal	60
FJ	Interior	Industrial arts 3	Exterior door and frame	Above and below	No	Wood	60
FK	Exterior	South arts entrance	Handrails	Below	No	Metal	100
FL	Exterior	Exterior of arts building Girls restroom	Window assemblies	Above and below	No	Wood	80
FM	Exterior	West side of arts building	Window assemblies	Above and below	No	Wood	320
FN	Exterior	West side of arts building	Trim below windows	Below	No	Wood	80
FO	Exterior	North arts building	Underside of roof overhang	Above	No	Metal	25
FP	Exterior	East side of arts building	Window assemblies	Above and below	No	Wood	320
FQ	Exterior	East side of arts building	Trim below windows	Below	No	Wood	80
FR	Exterior	North building entrance	Handrails	Below	No	Metal	120
FS	Exterior	Exterior of second floor landing, southeast stairwell	Window assemblies	Above	No	Wood	100
FT	Exterior	Northwest building entrance	Metal posts	Below	No	Metal	10
FU	Exterior	Classroom 12A	Handrails	Below	No	Metal	50
FV	Interior	Boiler room	Door and frame at top of stairs	Above and below	No	Wood	60
FW	Interior	Boiler room	Door and frame to exterior	Above and below	No	Wood	60
FX	Interior	Boiler room	Floor	Below	No	Concrete	1000
FY	Interior	Boiler room	Wall in southeast corner	Above	No	Concrete	40
FZ	Interior	Boiler room	West wall	Above and below	No	Concrete	80
GA	Interior	Boiler room office	Door and frame	Above and below	No	Wood	60

<b>ID</b>	<b>Interior / Exterior</b>	<b>Location</b>	<b>Structure</b>	<b>Above / Below five feet</b>	<b>K-2nd Grade</b>	<b>Substrate</b>	<b>Square Feet</b>
GB	Interior	Alarm room	Door and frame	Above and below	No	Wood	60
GC	Exterior	Stairs to boiler room storage	Handrails	Below	No	Metal	40

# Baumont Middle School 4043 NE Fremont 97212 Facility Plan



TOTAL SF  
ACRES  
1/4 SECT.

94,431  
5.72  
2634

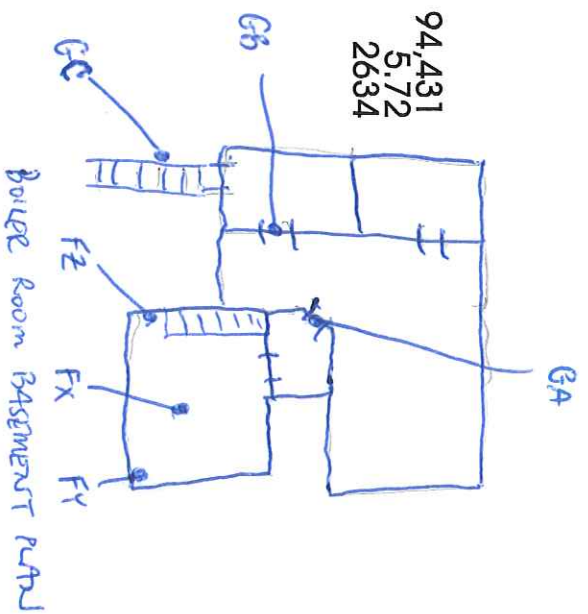



June 9, 2016

Clark R. Nelson  
PBS Engineering and Environmental Inc.  
4412 S.W. Corbett Ave  
Portland, OR 97239

800 NE Oregon Street, Suite 640  
Portland, OR 97232  
Phone: (971) 673-0440  
Fax: (971) 673-0457  
TTY Nonvoice: (971) 673-0372

RE: LEAD-BASED PAINT ACTIVITIES, INDIVIDUAL CERTIFICATION NO. 1806--Indv--R

This letter is your official notification that you have met the certification requirements under Oregon Administrative Rule (OAR) 333-069 to conduct lead-based paint activities in Oregon, in the following disciplines: Risk Assessor; Inspector

In addition to certification by the Oregon Health Authority, you are required to be licensed by the Construction Contractors Board (CCB) if you plan to conduct lead-based paint activities in Oregon. This license is different than, and in addition to, the standard contractor license issued by CCB. Both individuals and firms must obtain this license. For more information on CCB lead-based paint licensing, visit their web site at [www.oregon.gov/CCB](http://www.oregon.gov/CCB) or call 503-378-4621.

As a certified individual in Oregon, you must meet all the requirements of OAR 333-069, including work practice standards for conducting lead-based paint activities in target housing and child-occupied facilities. As a certified individual, you must perform work under a firm that is certified by the Authority for conducting lead-based paint activities.

You are required to wear the enclosed badge in plain view when conducting lead-based paint activities. Please note that the badge and certificate will expire on 6/30/2017. If you wish to maintain your certification after 6/30/2017, you must submit an application postmarked at least 60 days before expiration and document that your lead-based paint activities training is current.

As a public service the Authority publishes a list of individuals performing lead-based paint activities in Oregon. The list is distributed statewide to consumers interested in lead-based paint activities. Individuals that are certified by the state are eligible to be on this list.

If you have any questions concerning your certification or other aspects of the Lead-Based Paint Program, please contact program staff at 971-673-0440.

Sincerely,

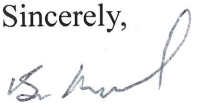
  
Ben Maynard  
Lead-Based Paint Program  
Oregon Health Authority

Enclosures: 1) Badge; 2) Certificate



**Clark R. Nelson**

**Risk Assessor  
Inspector  
Lead-Based Paint  
Activities  
CERTIFICATION  
# 1806--Indv--R  
6/30/2017**

Expires

CERTIFIED

State of Oregon  
Oregon Health Authority

**Clark R. Nelson**

is certified by the Oregon Health Authority to conduct Lead-Based Paint Activities

**Risk Assessor**

Certification Number:	1806--Indv--R
Issuance Date:	6/9/2016
Expiration Date:	6/30/2017



Oregon  
**Health**  
Authority



CLARK RICHARD NELSON  
4412 SW CORBETT AVE  
PORTLAND, OR 97239

**CONSTRUCTION CONTRACTORS BOARD  
LEAD BASED PAINT  
RISK ASSESSOR LICENSE**

EXPIRATION DATE: 6/24/2017

This document certifies that

CLARK RICHARD NELSON  
4412 SW CORBETT AVE  
PORTLAND, OR 97239

is licensed in accordance with Oregon Law as  
a Lead Based Paint Risk Assessor.

**9151806-RA**

**STATE OF OREGON  
CONSTRUCTION CONTRACTORS BOARD  
LEAD BASED PAINT  
RISK ASSESSOR LICENSE**

**LICENSE NUMBER: 9151806-RA**

This document certifies that:

CLARK RICHARD NELSON  
4412 SW CORBETT AVE  
PORTLAND, OR 97239

is licensed in accordance with Oregon Law as a Lead Based Paint Risk Assessor.

**License Details:**

LICENSE NO.: 9151806-RA  
EXPIRATION DATE: 6/24/2017

May 17, 2016

PBS Engineering and Environmental Inc.  
4412 SW Corbett Ave  
Portland, OR 97239

800 NE Oregon Street, Suite 640  
Portland, OR 97232  
Phone: (971) 673-0440  
Fax: (971) 673-0457  
TTY Nonvoice: (971) 673-0372

Attention: Derek May

RE: LEAD-BASED PAINT ACTIVITIES, FIRM CERTIFICATION NO. 1038--LBP FIRM

This letter is your official notification that PBS Engineering and Environmental Inc. has met certification requirements under Oregon Administrative Rules (OAR) 333-069 to conduct lead-based paint activities in Oregon. Please note that the enclosed certificate will expire on 6/30/2017.

In addition to certification by the Oregon Health Authority (Authority), PBS Engineering and Environmental Inc. is required to be licensed by the Construction Contractors Board (CCB) prior to conducting lead-based paint activities in Oregon. This license is different than, and in addition to, the standard contractor license issued by CCB. Both individuals and firms must obtain this license. For more information on CCB lead paint licensing, visit their web site at [www.oregon.gov/CCB](http://www.oregon.gov/CCB) or call 503-378-4621.

As a firm certified to conduct lead-based paint inspection activities in Oregon, PBS Engineering and Environmental Inc. must meet all requirements set forth in OAR 333-069. It must comply with standards for conducting lead-based paint inspection and/or risk assessment activities in target housing and child-occupied facilities and employ only certified individuals to conduct regulated activities.

As a public service, the Authority publishes a list of firms performing lead-based paint activities in Oregon. The list is distributed statewide to consumers interested in lead-based paint services. Only those firms that are certified by the state are eligible to be on this list.

If you have any questions concerning this certification or other aspects of the Lead-Based Paint Program, please contact program staff at (971) 673-0440.

Sincerely,



Ben Maynard  
Lead-Based Paint Program  
Oregon Health Authority

This document can be obtained in an alternate format by calling: (971) 673-0440.



State of Oregon  
Oregon Health Authority

**PBS Engineering and Environmental Inc.**

is certified by the Oregon Health Authority to conduct Lead-Based Paint Activities

Certification Number:	1038--LBP FIRM
Issuance Date:	5/16/2016
Date of Expiration:	6/30/2017

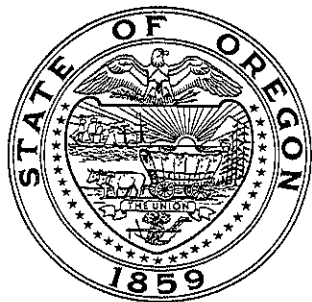

Oregon  
**Health**  
Authority

PBS ENGINEERING & ENVIRONMENTAL INC  
4412 SW CORBETT  
PORTLAND OR 97239

CONSTRUCTION CONTRACTORS BOARD  
LEAD INSPECTION CONTRACTORS LICENSE  
LICENSE No.: LBPI129143  
EXPIRATION DATE: 7/31/2017

This document certifies that

PBS ENGINEERING & ENVIRONMENTAL INC  
4412 SW CORBETT  
PORTLAND OR 97239

is licensed in accordance with Oregon Law as  
a Lead Inspection Contractor.

STATE OF OREGON  
CONSTRUCTION CONTRACTORS BOARD  
LEAD INSPECTION CONTRACTORS LICENSE

LICENSE NUMBER: LBPI129143

This document certifies that:

PBS ENGINEERING & ENVIRONMENTAL INC  
4412 SW CORBETT  
PORTLAND OR 97239

is licensed in accordance with Oregon Law as a Lead Inspection Contractor.

**License Details:**

LBPI LICENSE NO.: LBPI129143  
EXPIRATION DATE: 7/31/2017